

# Installation Instructions

Instrucciones de instalación, Instructions d'installation, Installationsanleitung, إرشادات التركيب

Installatie-instructies, Instruções de instalação, Installatie-instructies,

設置手順説明, Οδηγίες εγκατάστασης

Product Code: [4L2/7008 ]

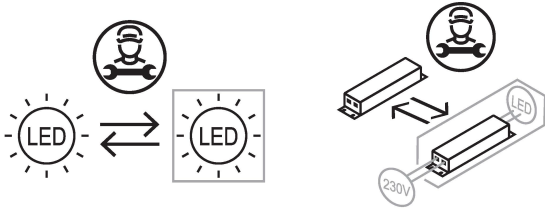

Please Visit  
<https://4liteuk.com>  
 downloads for our warranty  
 and translations

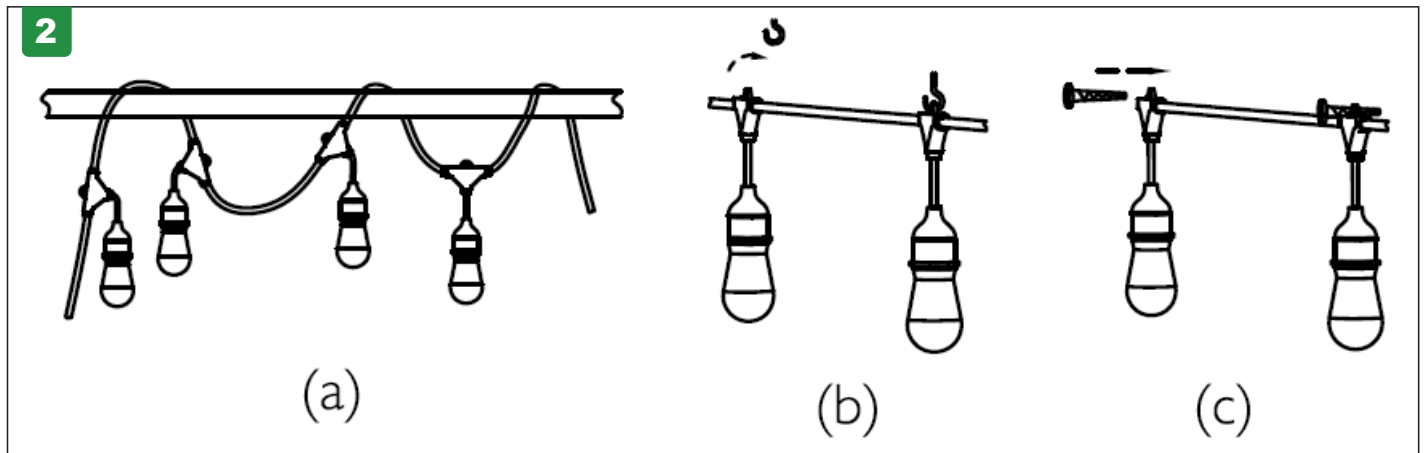
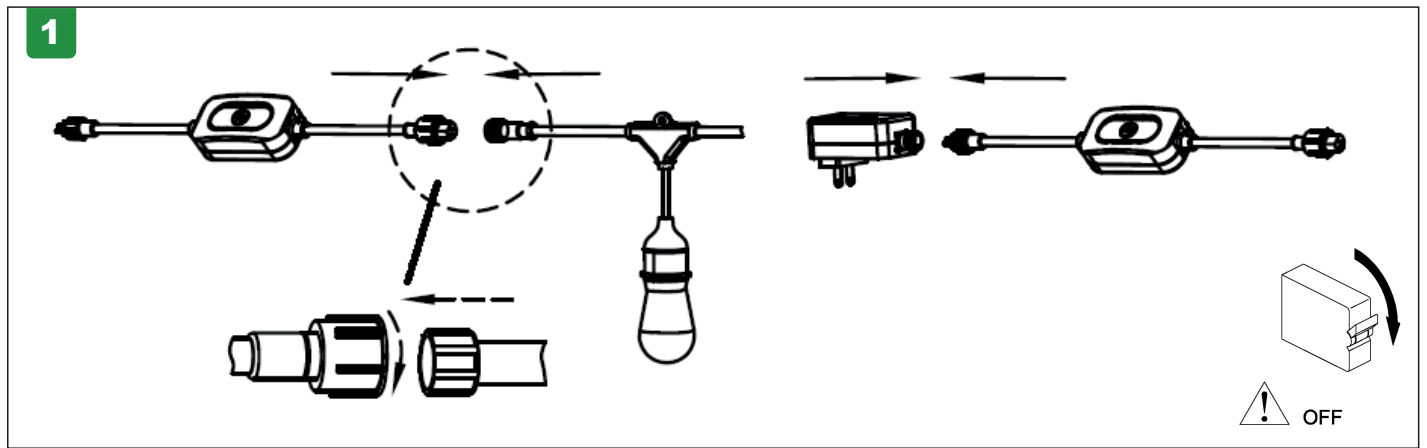
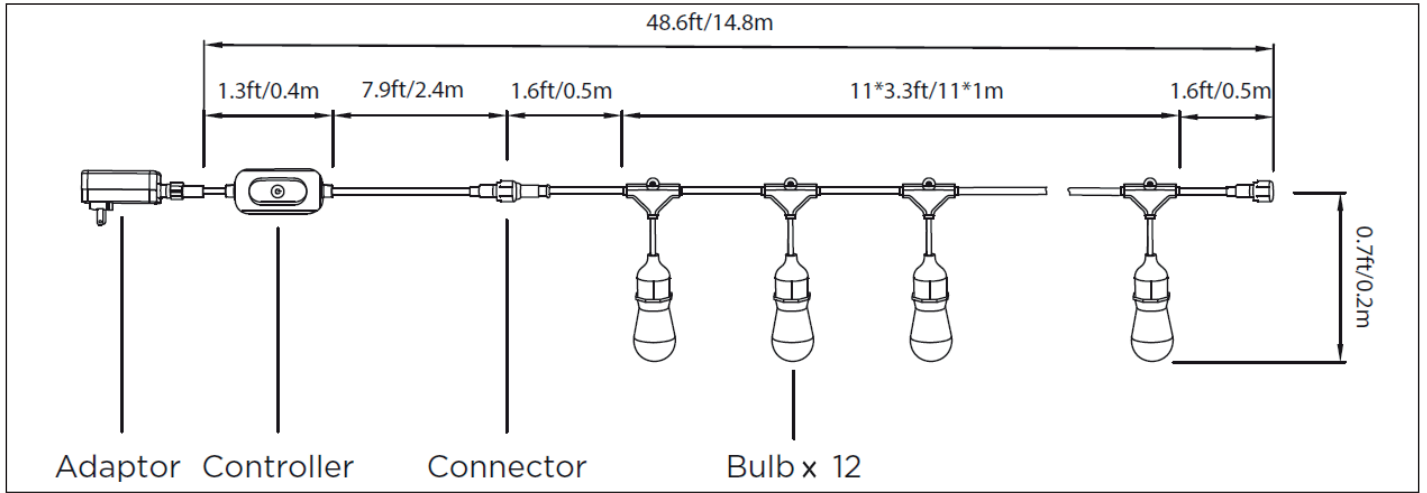
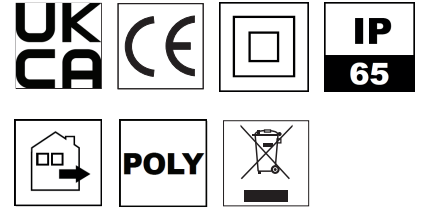

Ansell Electrical Products  
 Unit 6B, Stonecross Industrial  
 Park,  
 Yew Tree Way,  
 Warrington,  
 WA3 3JD

Ansell (Sales & Distribution)  
 Unit 2, M2 Business Park,  
 Duncrue Street,  
 Belfast,  
 BT3 9AQ

Ansell (Sales & Distribution) Republic of Ireland Limited  
 Unit G1, Block G,  
 Calmount Park, Calmount Avenue  
 Dublin 12,  
 D12 TH56

<https://4liteuk.com/>

Warrington Tel: +44 (0)1942 433333

Belfast Tel: +44 (0)2890 773750

International Tel: +44 (0)1942 433343

Spain Tel: 00 34 938 005642

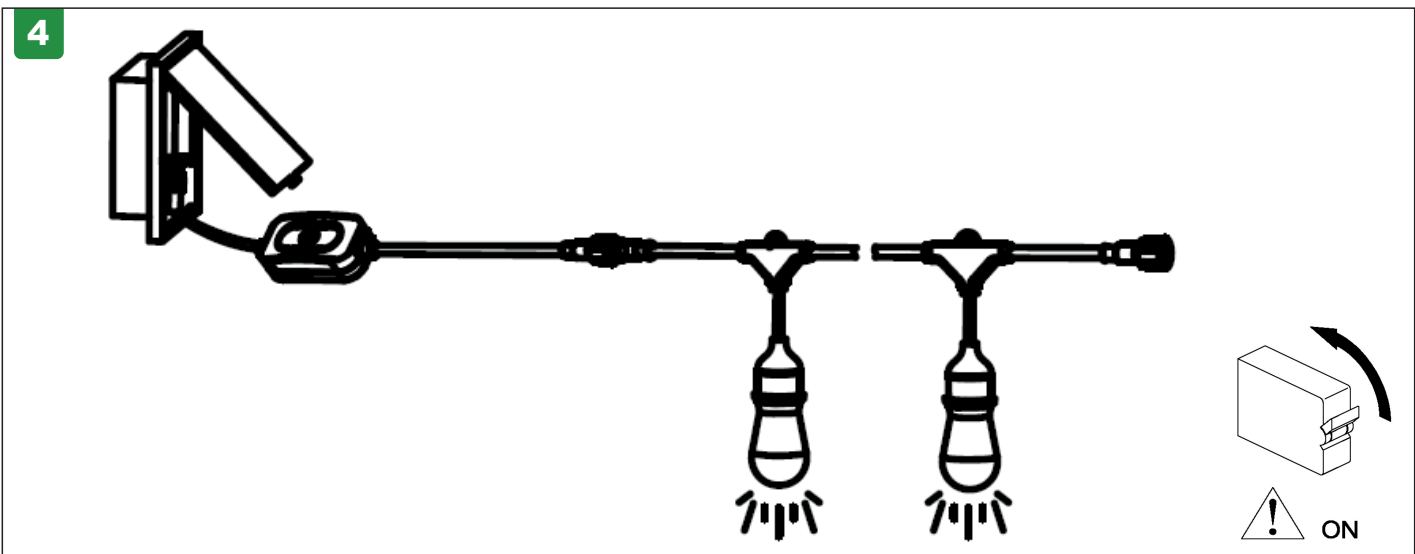
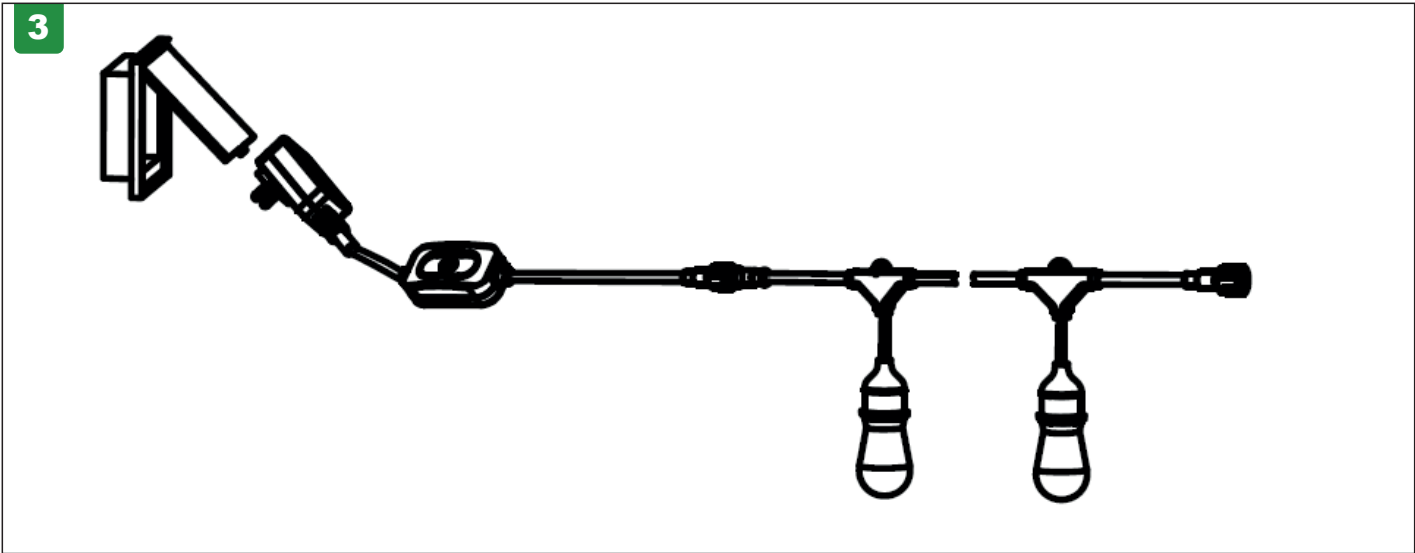

**Warning and safety instructions:**

- Use only the power supply (adaptor) provided with the lighting chain. The power supply (adaptor) is of IP20 only, it shall be installed at dry location.
- Do not connect the chain to the supply while it is in the packing.
- To reduce the risk of strangulation, the flexible wiring connected to this luminaire shall be effectively fixed to the wall if the wiring is within arm's reach.
- The light source contained in this luminaire shall only be replaced by the manufacturer or his service agent or a similar qualified person. Replace the light source only with specified 4pin light bulb (12VDC 1W).
- Ensure that all lampholders are fitted with a lamp.
- The lighting chain must not be used without all gaskets being in place.
- The external flexible cable or cord of this luminaire cannot be replaced. If the cord is damaged, the luminaire shall be destroyed.

**Simplified EU-DoC and UKCA-DoC**

Hereby, 4lite declares that the radio equipment type 4lite luminaires Connected by WiZ are in compliance with Directive 2014/53/EU (RED). The full text of the EU declaration of conformity is available at the following address: <https://4liteuk.com/>

Hereby, 4lite declares that the radio equipment type 4lite luminaires Connected by WiZ are in compliance with the Radio Equipment Regulation 2017 (S.I. 2017/1206). The full text of the UK declaration of conformity is available at the following address: <https://4liteuk.com/>

Ansell Electrical Products  
Unit 6B, Stonecross Industrial  
Park,  
Yew Tree Way,  
Warrington,  
WA3 3JD

Ansell (Sales & Distribution)  
Unit 2, M2 Business Park,  
Duncrue Street,  
Belfast,  
BT3 9AQ

Ansell (Sales & Distribution) Republic of Ireland Limited  
Unit G1, Block G,  
Calmount Park, Calmount Avenue  
Dublin 12,  
D12 TH56

<https://4liteuk.com/>