

# Gen Bay emergency pack

## Self & Manual Test Switchable Emergency Converter

Installation instructions



collingwood

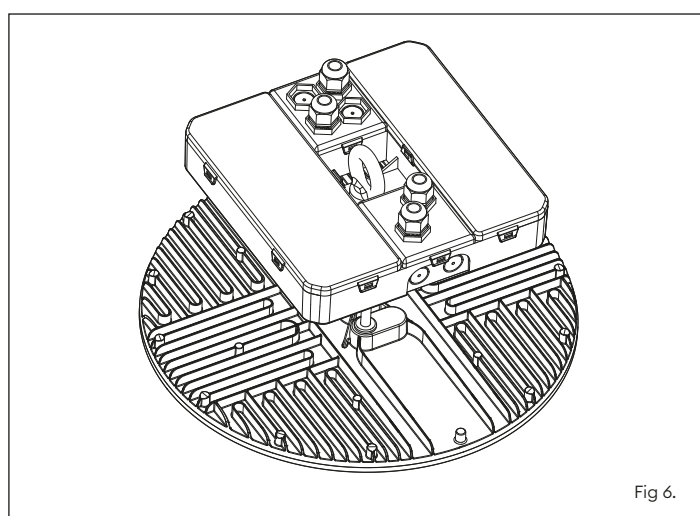
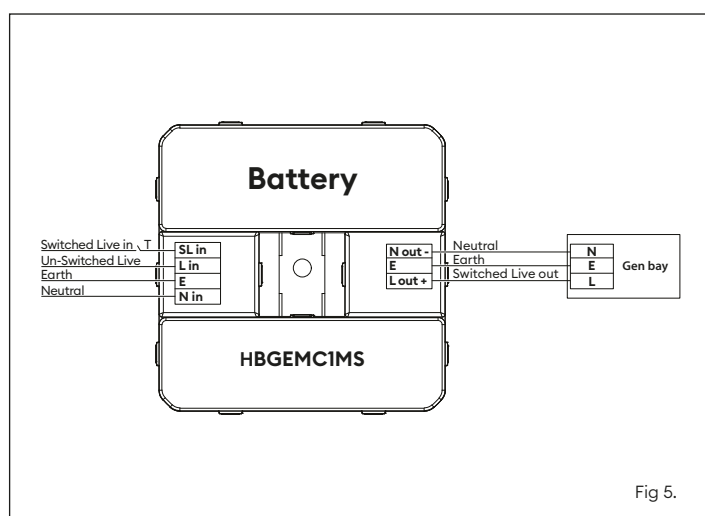
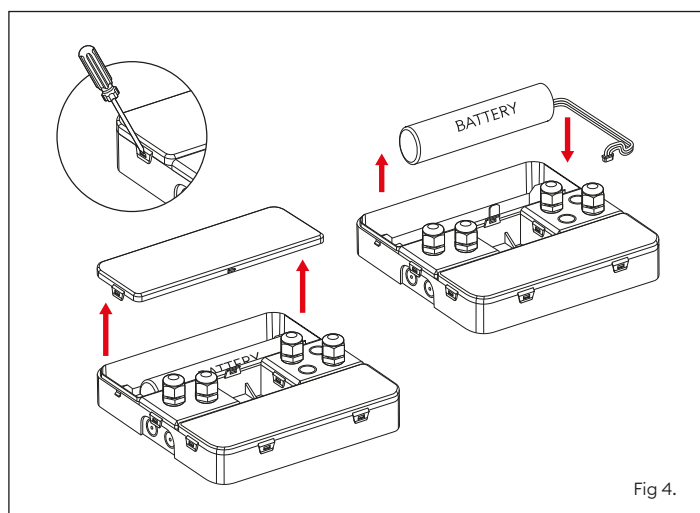
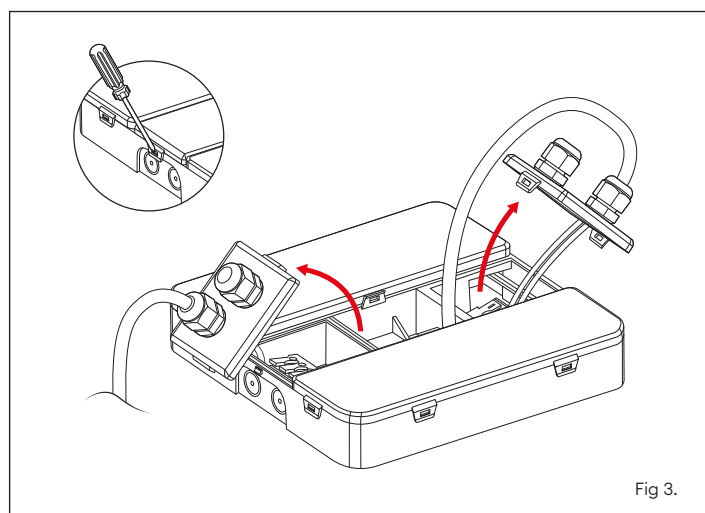
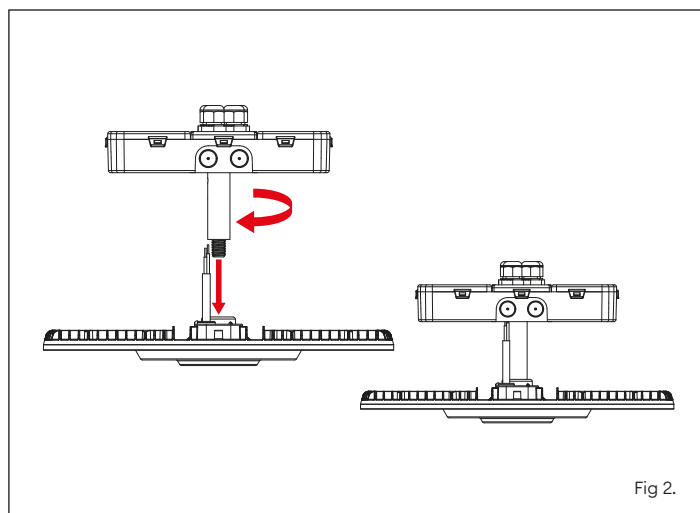
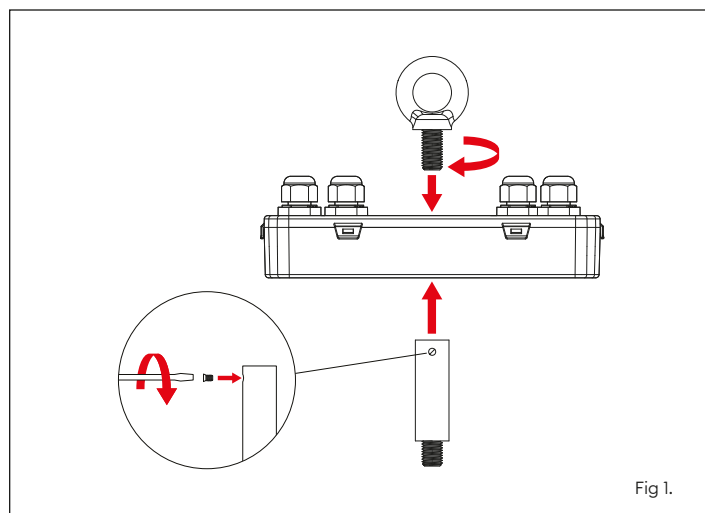

# Gen Bay emergency pack

## Self & Manual Test Switchable Emergency Converter

### Installation instructions



collingwood

#### Installation

1. Refer to the LED unit installation instructions and install all non-emergency LED units.
2. Assemble the supplied spacer, M10 loop and the HBGEMCIMS together (Fig 1).
3. Fix the emergency pack onto the highbay using the supplied spacer and M10 loop (Fig 2).  
**Note:** Tighten the securing screw at the side of the loop and the spacer.
4. Feed the cables through the glands supplied. The input has two glands to enable loop in loop out function (Fig 3).  
**Note:** Use the spare M16x1.5 caps to replace the spare entry gland if required.
5. Connect the battery and write installation date on the battery. Battery is installed in the emergency pack housing, to remove it open the end cover and pull the battery (Fig 4).
6. Connect the input of the Gen Bay to the output of the HBGEMCIMS (Fig 5); L out = Switched Live (Brown), E= Earth (Green and Yellow), N out = Neutral (Blue).
7. Connect the mains supply to the terminals inside the gland covered compartments (Fig 3 and 5). L in = Unswitched Live, N in = Neutral, E = Earth, SL in = Switched Live
8. Secure the cables by tightening the cable glands to maintain the ingress protection.
9. Switch the emergency converter to the appropriate testing mode, please see the explanation in the **Function switching** section.  
**Note:** Self-Test will be the standard setting.
10. Hang the high bay using a suitable chain and attach to the supplied M10 hanging loop (Fig 6).
11. See section emergency pack commissioning.

#### Installation Data

- Isolate the mains supply, prior to wiring.
- This unit must be wired by a qualified electrician or suitable competent person.
- Plug the battery in before installation.
- Do not cover emergency pack with insulation.
- Use only with LED modules, ensuring the supplied emergency markings are placed on the luminaire.
- Input Voltage 220-240V AC 50/60Hz.
- Battery must be replaced when the unit no longer meets its rated emergency duration, or if a battery fault occurs. Contact Collingwood Lighting for a suitable replacement.

#### Emergency pack commissioning

1. Reset the self-test counter to 0 – hold test button for at least 10s.
2. Provide an uninterrupted mains power supply (permanent live) for 24 hours.
3. Check that the green indicator LED light is lit, this confirms that the battery is charging.
4. Initial duration test will start automatically 24h after installation.
5. After a successful duration test, the green LED will be flashing for 5 days, allowing the user to acknowledge it.

#### Function switching

- While the LED is powered via Mains and switched on, hold the test button for 5 seconds to select between manual and self-test function.
- If the **red** LED is quickly flashing (0.25s intervals) then the **manual test** has been selected.
- If the **green** LED is quickly flashing (0.25s intervals) then the **self-test** has been selected.
- Once selected, hold the test button for 10s to confirm the selection.

| LED indicator status                        | Comment   |
|---|---|
| Green LED on                                | Product connected and functioning correctly                                 |
| Green LED flashing (approx. 0.5s interval)  | Functional test in progress   |
| Green LED flashing (approx. 1s interval)    | Successful duration test - flashing for 5 days<br>Duration test in progress |
| Red LED on                                  | LED unit failure  |
| Red LED flashing (approx. 0.5s interval)    | Battery duration test failure   |
| Red LED flashing (approx. 1s interval)      | Battery fault – short circuit, open circuit, incorrect battery voltage      |
| Red LED flashing (approx. 1s on and 3s off) | Battery thermal protection has disabled charging and discharging*           |

\*Ensure the installation temperatures are within the ambient temperature range of the product.



Disposal of this product should be separate from household waste. Please separate these items from other types of waste and recycle them responsibly to promote the sustainable reuse of material resource. Household users should contact their local government office for details of where and how they can take these items for environmentally safe recycling.



3 year warranty

en t +44 (0) 1604 495 151 | f +44 (0) 1604 495 095 | e sales@collingwoodgroup.com | w collingwoodlighting.com  
Collingwood Lighting, Brooklands House, Sywell Aerodrome, Sywell, Northampton NN6 0BT, United Kingdom

fr t +32 (0)4 351 91 40 | e info@indigo-lighting.com | w www.indigo-lighting.com  
Indigo S.A. / N.V. Rue de la légende 32 G, 4141 Srimont – Belgique

Emergency installation and maintenance record

Product : \_\_\_\_\_

Installer : \_\_\_\_\_

Date installed : \_\_\_\_\_

Commissioning by : \_\_\_\_\_

Date commisioned : \_\_\_\_\_

| Year 1 |        |      | Year 2 |      | Year 3 |      | Year 4 |      | Year 5 |      |
|--------|--------|------|--------|------|--------|------|--------|------|--------|------|
| Month  | Signed | Date | Signed | Date | Signed | Date | Signed | Date | Signed | Date |
| 1      |        |      |        |      |        |      |        |      |        |      |
| 2      |        |      |        |      |        |      |        |      |        |      |
| 3      |        |      |        |      |        |      |        |      |        |      |
| 4      |        |      |        |      |        |      |        |      |        |      |
| 5      |        |      |        |      |        |      |        |      |        |      |
| 6      |        |      |        |      |        |      |        |      |        |      |
| 7      |        |      |        |      |        |      |        |      |        |      |
| 8      |        |      |        |      |        |      |        |      |        |      |
| 9      |        |      |        |      |        |      |        |      |        |      |
| 10     |        |      |        |      |        |      |        |      |        |      |
| 11     |        |      |        |      |        |      |        |      |        |      |
| 12     |        |      |        |      |        |      |        |      |        |      |



Disposal of this product should be separate from household waste. Please separate these items from other types of waste and recycle them responsibly to promote the sustainable reuse of material resource. Household users should contact their local government office for details of where and how they can take these items for environmentally safe recycling.



3 year warranty