

Safety Information

>All electrical work must be undertaken by a qualified contractor to ensure compliance with latest edition BS7671 and IEE/IET wiring regulations.

>Before installing a LED IP65 Bulkhead or doing any maintenance, ensure power supply is turned off at the circuit breaker or fuse box.

>This product is designed for permanent connection to fixed wiring; the circuit should be protected with the appropriate MCB or fuse.

Environment

>Please DO NOT dispose of electrical items or packaging as unsorted of electrical items waste. Use the recycling facilities provided by your local authorities.

PRODUCT DIMENSIONS

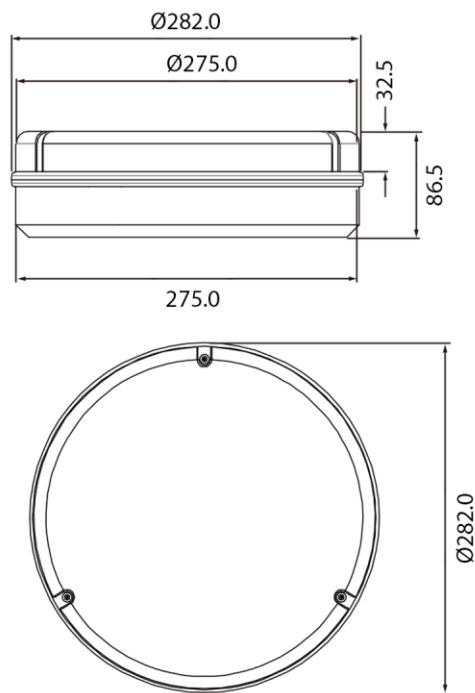

All dimensions in mm

Important Warranty Information

The IP65 Bulkhead has a 3 years warranty. To claim you must provide the product part number and date of manufacture, which can be found on the label attached to the luminaire housing along with the original purchase invoice. The Emergency batteries carry a 1 year warranty only.



Certificate No. FS 590684



Certificate No. EMS 590685

NET LED Lighting
Buckingham Business Park
300 Anderson Road
Cambridge
CB24 4UQ
sales@netled.co.uk
www.netled.co.uk

Technical Helpline: 01223 851505
Email: support@netled.co.uk

www.netled.co.uk/downloads

Distributed by



NEWTON POLYCARBONATE IP65 BULKHEAD INSTALLATION GUIDE

Part Number	Description
NET-33-06-52	Tri-colour - Standard
NET-33-06-54	Tri-colour - Emergency
NET-33-06-50	Tri-colour - Self Test Emergency
NET-33-06-56	Tri-colour - Motion Sensor
NET-33-06-58	Tri-colour - Motion Sensor EMG
NET-33-06-51	Tri-colour - Motion Sensor Self Test EMG
NET-33-06-76	Tri-colour - Photocell
NET-33-06-77	Tri-colour - Photocell EMG
NET-33-06-80	4000K - Standard
NET-33-06-88	4000K - Emergency
NET-33-06-84	4000K - Self Test Emergency
NET-33-06-86	4000K - Motion Sensor

SUPPLY/EARTH CLASS

220-240V AC 50/60 Hz

Fig.1 Mains Input Termination



Class I

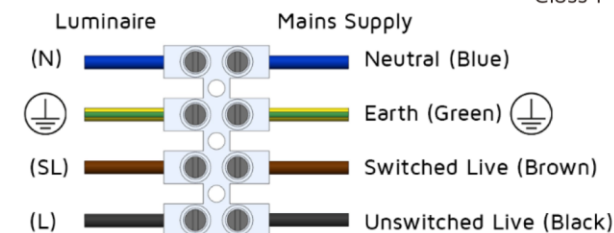

Installation procedure: Carefully read the instructions and ensure the mains supply is isolated before installation. Please follow the safety information overleaf before carrying out any installation. Please retain this overlet for future reference.



Replaceable (LED only) light source by a professional



Replaceable control gear by professional

Step 1: Remove the screws, then take off the cover.

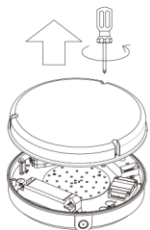

Step 2: Drill out a knockout and install a waterproof cable gland. Feed the cable through the gland.

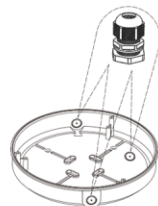

Step 3: Drill out the screw holes and fix the base to the mounting surface.

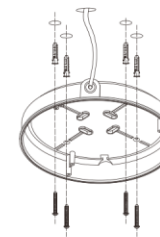

Step 4: Install the LED Gear Tray into the housing by fixing the three screws in place. Wire the Gear Tray as per the wiring diagram below.

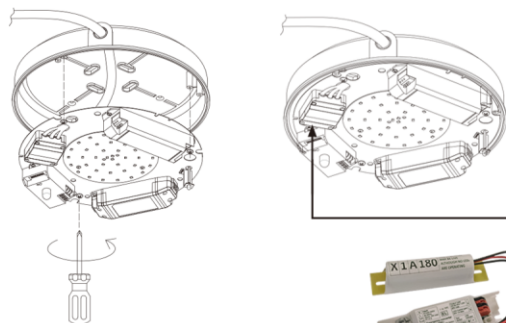

2D Bulkhead Emergency wiring

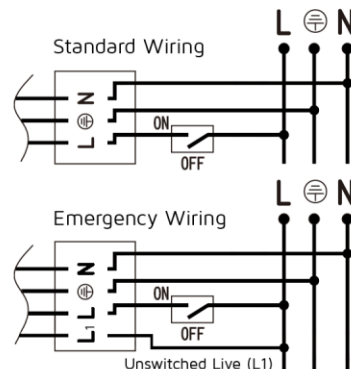

Step 5: Fix the cover to the body with the screws provided.

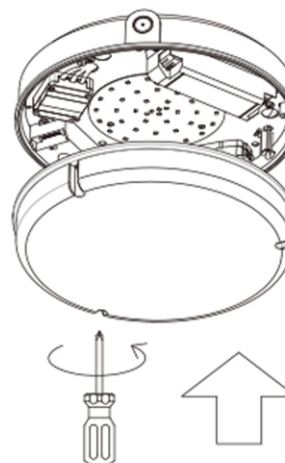

Photocell Sensor Configuration (Only for units with the Photocell Sensor option):

Night/Light Sensor Function

	1	2	3	4	open	close
I	ON	ON	ON	ON	5Lux	25Lux
II	ON	ON	ON	-	10Lux	50Lux
III	ON	ON	-	ON	25Lux	75Lux
IV	ON	ON	-	-	50Lux	100Lux
V	ON	-	ON	-	100Lux	200Lux
VI	ON	-	-	-	150Lux	300Lux
VII	-	ON	-	-	200Lux	400Lux
VIII	-	-	-	-	Disable	

← Default Settings



When ambient light is below the open lux level, the sensor automatically switches on the luminaire at 100% brightness. When ambient level is over close lux level, the luminaire switches off.

Important Battery Warranty Information

The Battery has a 1 Year Warranty. To claim, you must provide the part number and date of manufacture, which can be found on the label attached to the luminaire housing along with the original purchase invoice.

Microwave Motion Sensor Configuration - These settings are only for the Bulkheads with Microwave Motion Sensor option.



Please note: Dip switch in the up position is ON.

Detection area can be changed by selecting the combinations below on the DIP switches. Maximum detection area 12m.			Refers to the time period the lamp remains at 100% illumination after no motion is detected.			The sensor can be set to only allow the lamp to illuminate below a defined ambient brightness threshold. When set to Disable mode, the daylight sensor will switch on the lamp when motion is detected regardless of ambient light level.			Refers to the time period the lamp remains at a low light level before it completely switches off in the long absence of people. When set to "+∞", the low light is maintained until motion is detected. When set to "0s", the light will turn off after hold time.		
Detection Area			Full Brightness Hold Time			Daylight Sensor			10% Corridor Function Time		
ch1	ON	100%	ch3	ON	5S	ch5	ON	Disable	ch7	ON	Off/0s
ch2	ON		ch4	ON		ch6	ON		ch8	ON	
ch1	—	75%	ch3	—	90S	ch5	—	50Lux	ch7	—	30s
ch2	ON		ch4	ON		ch6	ON		ch8	ON	
ch1	ON	50%	ch3	ON	3min	ch5	ON	15Lux	ch7	ON	10min
ch2	—		ch4	—		ch6	—		ch8	—	
ch1	—	25%	ch3	—	10min	ch5	—	5Lux	ch7	—	Always On/+∞
ch2	—		ch4	—		ch6	—		ch8	—	

*Default Set Up On Delivery

[illegible]