

Track Mount

1. Remove the bracket with a flat screwdriver.

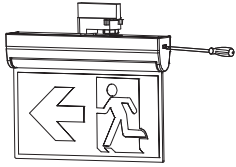

2. Connect the AC supply wires to the terminal, plug it onto the PCBA, and connect the battery.

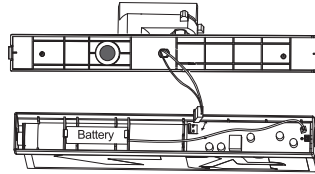

DALI wiring

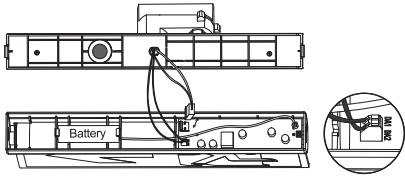

3. Snap the luminaire onto the mounting bracket. Fix the track adaptor onto track, turn clockwise or anti-clockwise until the light is on.

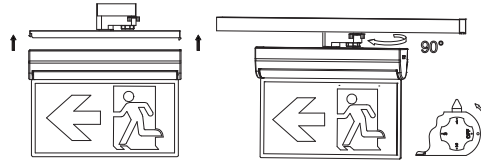

Side Mount

1. Fasten the side mount kit to the wall.

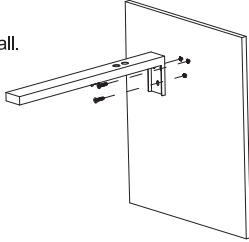

2. Remove the top bracket with a flat screwdriver.

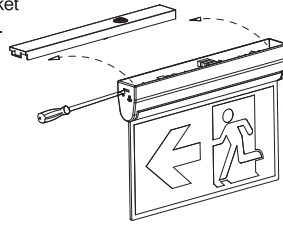

3. Fasten the top bracket to the side mount kit. Connect the AC supply wires to the terminal, plug it onto the PCBA, and connect the battery. After that fasten the main body to the top bracket.

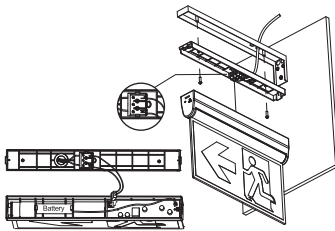

4. Complete the installation.

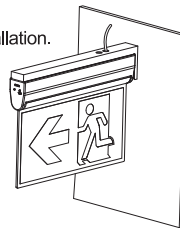

Instructions for automatic test option

1. Once the unit is powered up it will automatically initiate a self test and diagnostics as follows:

- At every times: Check for battery disconnection, charge board fault, lamp fault and transfer fault.
- Every month: Performs 3 minutes functional test.
- Every year: Performs 1/3 hours duration test

All test functions are factory preset and do not need field adjustment.

NOTE: After repairing a service fault, press and hold the test button for 2 seconds to test the flashing indicator light to green.

2. Dual Colour Indicator LED Status Meanings
- Green Solid On Ready / Normal Operation
 - Red Requires Services

•	One flashes, 4 second pause	Battery not connected
••	Two flashes, 4 second pause	Low battery voltage
•••	Three flashes, 4 second pause	Charge board fault
••••	Four flashes, 4 second pause	AC/DC transfer fault
•••••	Five flashes, 4 second pause	LED lamp fault

3.Button Test

Press test button once	30 seconds duration test
Press test button twice with 2 seconds	3 minutes duration test
Press test button 3 times within 2 seconds	30 minutes duration test
Press test button 4 times within 2 seconds	1/3 hours duration test

ROTATABLE DESIGN LED EXIT SIGN

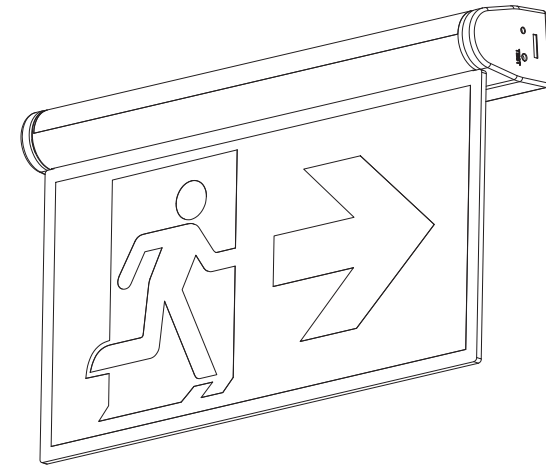

▼ Precautions

Normal Operation: The green LED indicator stays on when connected to mains supply. The indicator will turn off when the mains supply fails, or when the internal charger malfunctions, or when the luminaire is in test mode.

Battery: Li-Ion rechargeable battery pack. Battery should be replaced when it reaches the end of its lifetime. To avoid damage to the luminaire and ensure its performance, the battery should be replaced with same type.

Test Switch: Press the test button, LED indicator will turn off and the luminaire will be powered by the battery pack. The light source is non-replaceable. When the light source reaches the end of its lifetime, the whole luminaire shall be replaced.

▼ Installation Procedure

WARNING ⚡

1. Switch off before installation or maintenance.
2. Switch on only after complete installation and examination of the circuit.
3. Professional electrician for installation and maintenance only.
4. This luminaire is not intended for use in high-risk task area lighting.

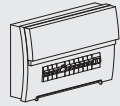

Turn Off
Power Supply

Read instructions and check you have all the tools and accessories to complete the installation correctly.

▼ Surface Mount (Ceiling/ Wall mount)

1. Remove the bracket with a flat screwdriver

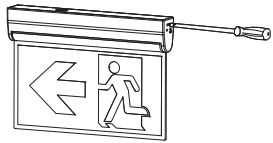

2. Fix the bracket onto the surface (ceiling/ wall)

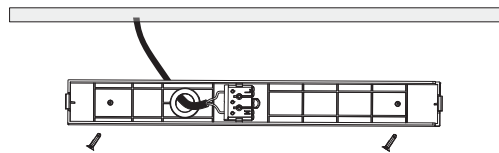

3. Connect the AC supply wires to the terminal, plug it onto the PCBA, and connect the battery.

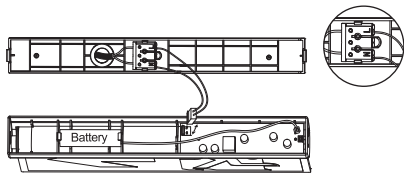

DALI wiring

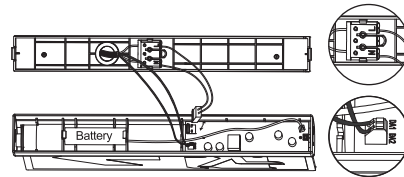

* Wire "L""N" to terminal block, wire 2 x DALI signal wires to terminal on PCB

4. Snap the luminaire onto the mounting bracket. Switch on, the green LED indicator will be on.

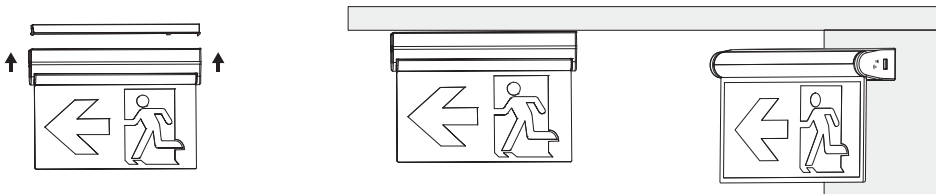

▼ Recessed Mount (Recessed kit sold separately)

1. Take out the recessed kit, and put the luminaire through. Remove the bracket with a flat screwdriver.

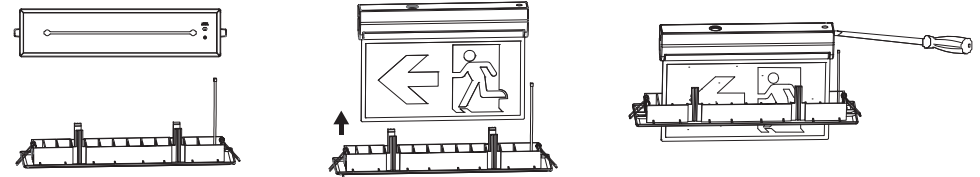

2. Knock out the bracket's hole and put the wire through it. Connect the plug onto the recessed kit.

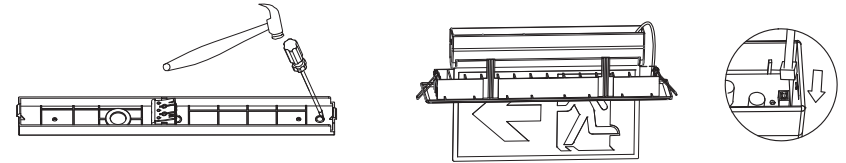

3. Cut out size: L395-410mm x W65-90mm. Fix the luminaire onto the ceiling. Switch on, the green LED indicator will be on.

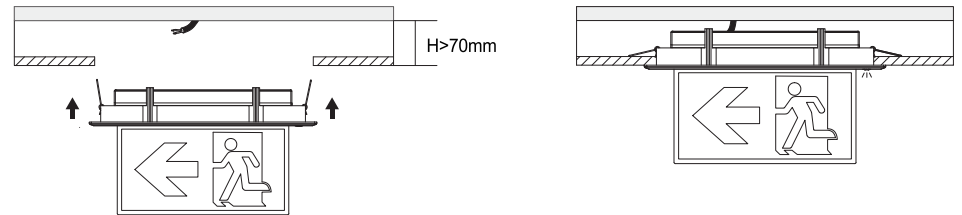

▼ Pendant Mount

1. Knock out the screw holes and fix steel wire rope on the mounting bracket and the ceiling at both ends. Adjust the rope to suitable length before fixing the screws.

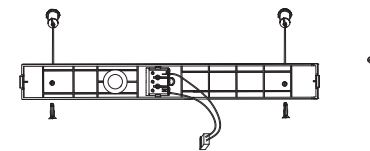

2. Connect the AC supply wires to the terminal, plug it onto the PCBA, and connect the battery.

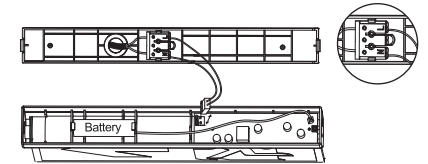

DALI wiring

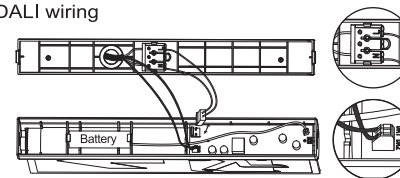

3. Snap the luminaire onto the mounting bracket.

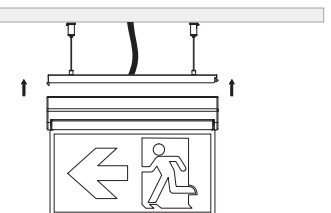

* Wire "L""N" to terminal block, wire 2 x DALI signal wires to terminal on PCB