



Date	Revision
24.5.2022	2

# Installation Instructions: Firestay LED Downlight 10515/10516/10517

## Read these instructions before installation and retain for future reference

- We recommend that luminaires are installed by a qualified electrician ensuring the installation complies with current IEE wiring regulations BS7671:2018 & local building control.

- Bell will not accept responsibility for any claims arising from a poor installation.
- The light source of this luminaire is not replaceable: when the light source reaches end of life, the whole luminaire must be replaced.

## Important user advice

- The ambient room temperature should not exceed 35°C.
- Ensure that there is adequate free air ventilation around the fitting.
- It may be necessary to uprate your MCBs to allow for increased inrush current.
- Always switch off mains supply before installing.

This product may contain substances that can be hazardous to the environment if not disposed of properly. Electrical and electronic equipment should never be disposed of with general household waste but must be separated for its correct treatment and recovery.

Where possible recycle your packaging.



## Read these instructions before installation and retain for future reference

**This equipment should be installed by a competent electrician** ⚠

### Installation:

1. Cut a suitable hole in the ceiling as per the cut-out details Ø70mm ensuring that it does not infringe with electrical cables, water/gas pipes or ceiling joists. (see Fig 1)
2. Wire the female connector (separately packed) to the circuit, make the necessary circuit tests. Connect the male connector (the one which is connected to the lamp) to the male connector ensuring that they are fully 'Clicked' together. (see Fig 2)
3. Fold spring clips upwards, and insert fitting into the hole. (see Fig 3)
4. Release spring clips to hold fitting in place and test for correct operation. (See Fig 4)

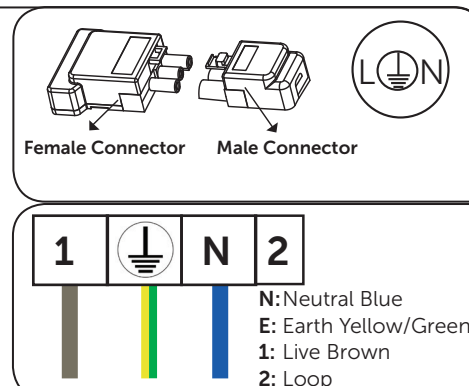
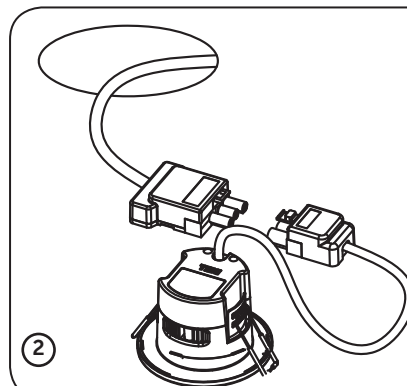
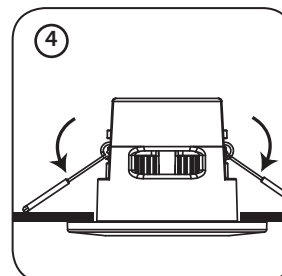
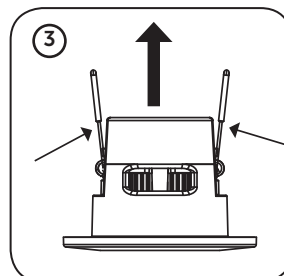
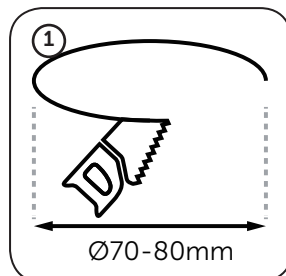

### Bezel Fitting:

The lamp is supplied complete a satin magnetic bezel and white bezel fixed on the fitting.

To change bezels simply place the satin magnetic bezel over the white bezel.

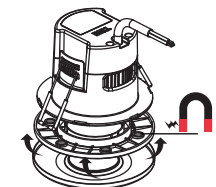

### Measurements:

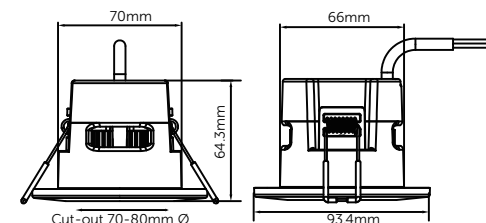

### Insulation Coverable (IC Rated)

The lamp is designed for use with insulation material so that it does not need extra IC cage accessories.

Maximum insulation depth 300mm

