

Installation Instructions: LED panels

Read these instructions before installation and retain for future reference.
This equipment should be installed by a competent electrician.



Important Information

We recommend that luminaires are installed by a qualified electrician ensuring the installation complies with current IEE wiring regulations BS7671:2018 & local building control.

- All tests should be carried out in accordance to EN 50172:2004.
- BELL will not accept responsibility for any claims arising from a poor installation.
- The light source of this luminaire is not replaceable: when the light source reaches end of life, the whole luminaire must be replaced.
- Philips driver is not polarity dependent.

Warning Before installation ensure power is disconnected

- 3 fixings on 1200 panels when using suspended installation.
- 6 fixings on 1200 panels when using flush mounting installation kit.

This product may contain substances that can be hazardous to the environment if not disposed of properly. Electrical and electronic equipment should never be disposed of with general household waste but must be separated for its correct treatment and recovery. Where possible recycle your packaging.



NOT Insulation Coverable

Not suitable for covering with insulation material



Suspended Installation

Y shape suspension kits attach the panels to ceilings.

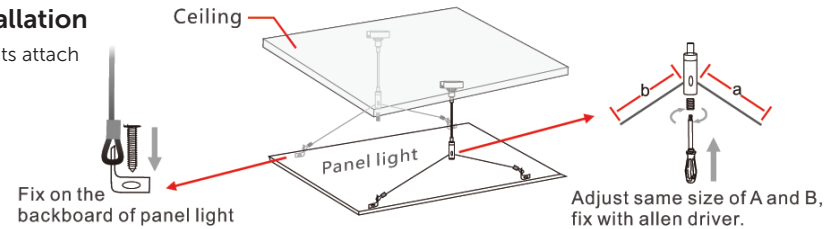

Recessed Installation

Exposed T-grid: Lay-in in exposed T-grid.

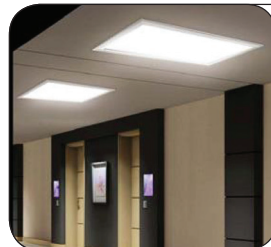
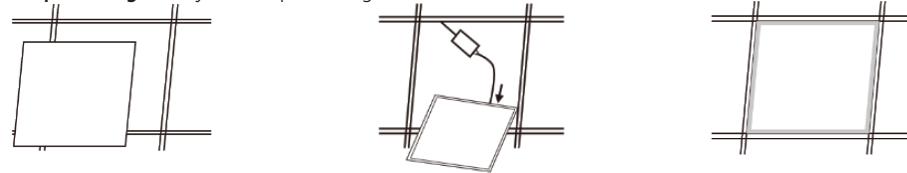

Flush Installation

Plaster ceiling: flat spring steel clips ensure fast installation to Plasterboard ceilings.

Cut out 580x580mm

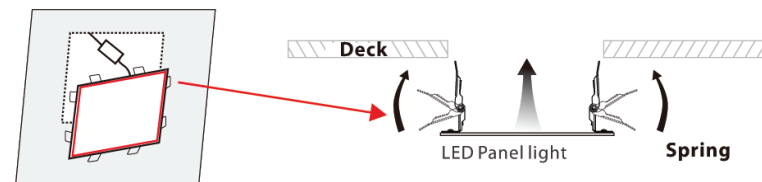

Surfaced Mounted Installation

Innovative design surface0 mounting shows no visible fixing screws.

