

Read these instructions before installation and retain for future reference. This equipment should be installed by a competent electrician 

Power	Voltage	CCT	CRT	lm	LED light Specification Source	LED Number	L (mm)	W (mm)	H (mm)	LF (mm)
25W	220-240 50/60Hz	4000	80	3000	SMD2835	130	1536	90	90	1000
52W	220-240 50/60Hz	4000	80	6000	SMD2835	270	1536	130	90	1000
60W	220-240 50/60Hz	4000	80	6900	SMD2835	XX	XX	XX	XX	XX

Important Information

We recommend that luminaires are installed by a qualified electrician ensuring the installation complies with current IEE wiring regulations BS7671:2018 & local building control.

- All tests should be carried out in accordance to EN 50172:2004.
- BELL will not accept responsibility for any claims arising from a poor installation.
- The light source of this luminaire is not replaceable: when the light source reaches end of life, the whole luminaire must be replaced.
- Not suitable for petrochemical installations.
- Upgrading of MCB may be necessary
- 1 year warranty on battery

Warning Before installation ensure power is disconnected.

This product may contain substances that can be hazardous to the environment if not disposed of properly. Electrical and electronic equipment should never be disposed of with general household waste but must be separated for its correct treatment and recovery.

Where possible recycle your packaging.

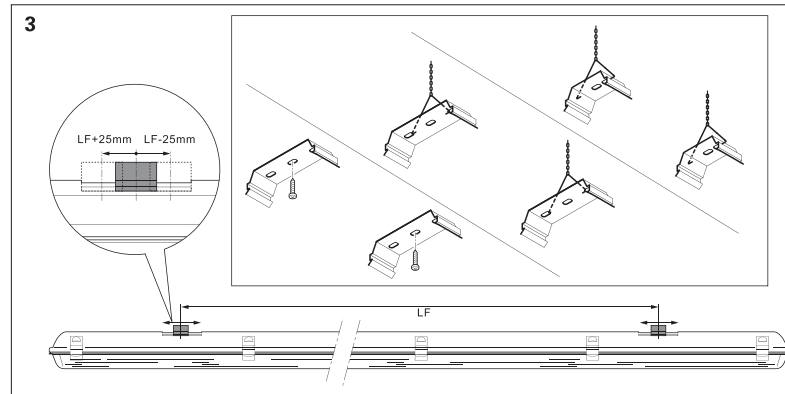
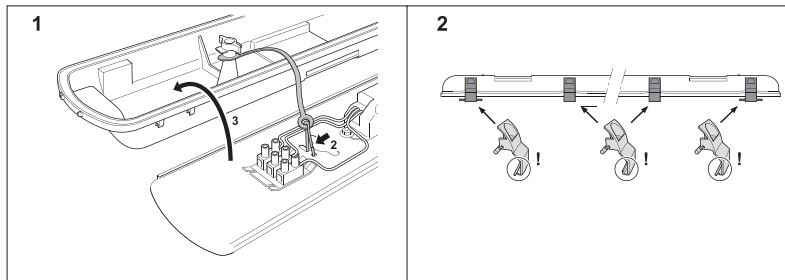
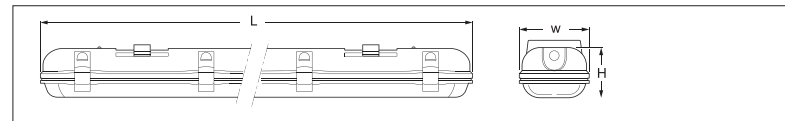

IP65 CE   

Emergency

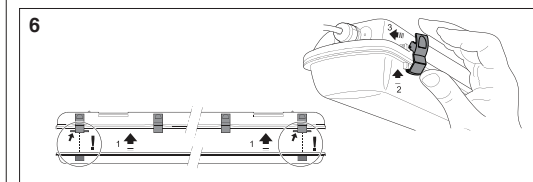
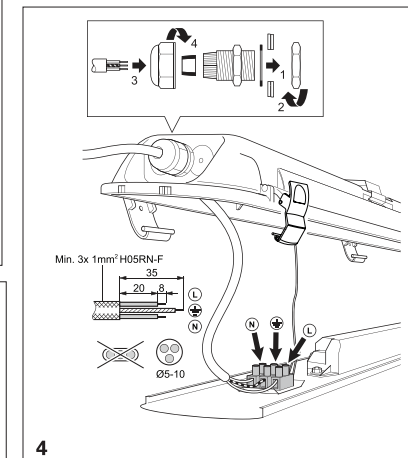
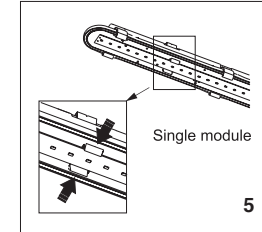
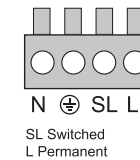

Testing & Commissioning for Emergency Luminaire

- Ensure the Load is connected.
- Connect the battery.
- Switch on the Unswitched Supply
 - Check the Charge LED illuminates.
- Switch on the Maintained Supply
 - Check the LED illuminates as normal.
- Switch off the Maintained Supply.
- Switch off the Unswitched Supply
 - Check the Charge LED extinguishes and the load LED illuminates at a reduced output.
- Enter the commissioning date on the Battery Pack.
Switch on the Unswitched Supply

Luminaire Ref/Location _____			In Case of difficulty, contact the Installation Engineers:- _____ Tel: _____							
Full Recharge Time 24 Hours			Duration 3 Hours				Lamp Type - LED			
ROUTINE TEST RECORD										
	Year 1		Year 2		Year 3		Year 4		Year 5	
Monthly Test	Signed	Date	Signed	Date	Signed	Date	Signed	Date	Signed	Date
Functional										
Functional										
Functional										
Functional										
Functional										
Functional										
Functional										
Functional										
Functional										
Functional										
Functional										
Functional										
Three Hour										

Detection range setting (sensitivity)

Detection range is the term used to describe the radius of the more or less circular detection zone produced on the ground after mounting the sensor light at a height of 2.5m. Put the switch to the ON position as "1", put switch to the OFF position as "0", switch location and detection range of the corresponding table is as follows:

S1	S2	
ON	ON	
1	2	
S1	S2	detection range
0	0	2m
0	1	5m
1	0	8m
1	1	10m

SENS: S1, S2

Note: The above detection range is gained if the detected person is between 1.6m~1.7m tall and moves at a speed of 1.0~1.5m/second. If the subjects size is different and speed changes, the detection distance will also change.

Attention: When using this product, please adjust the sensitivity to an appropriate position, please do not adjust the sensitivity to maximum, in case the product works abnormally because of motion detection including blowing leaves & curtains, small animals, or even power grid & electrical equipment. All of the above can lead to abnormal operation. When the product does not work normally, please try to turn down the sensitivity, and then test it.

Time Setting: The light can be set to stay ON for any period of time between approx. 10sec and a maximum of 30min. Any movement detected before this time elapse will re-start the timer. It is recommended to select the shortest time for the detection zone and for performing the walk test. Put switch to the ON position as "1", put switch to the OFF position as "0", switch location and detection range of the corresponding table is as follows:

S3	S4	S5	TIME
0	0	00	10s
0	0	1	1min
0	1	0	5min
0	1	1	10min
1	0	0	15min
1	0	1	20min
1	1	0	25min
1	1	1	30min

SENS: S3, S4, S5

Note: After the light switches OFF, it takes approx. 4 seconds before it is able to start detecting movement again. The light will only switch on in response to movement once this period has elapsed.

Light control settings: The chosen light response threshold can be set from approx. 10-500lux, put switch to the ON position as "1", put switch to the OFF position as "0", switch location and light-control of the corresponding table is as follows:

S6	S7	S8	LUX
0	0	0	24H
0	0	1	10LUX
0	1	0	20LUX
0	1	1	50LUX
1	0	0	100LUX
1	0	1	200LUX
1	1	0	300LUX
1	1	1	500LUX

LUX: S6, S7, S8

WARNING Do not install if:

1. The mounting surface is unstable or rocking
2. There is constant movement within the detection range eg. flapping curtains or conveyor belts.
3. Traffic is passing within the detection area.

Malfunction	Cause	Remedy
The light will not come on	Wrong light control setting selected Mains switch off	Adjust settings Switch On
Light always on	Continuous movement in the detection zone	Check zone settings
Light comes on with no identifiable movement	Sensor not mounted for detecting movement reliably Movement occurs but not identified (movement behind wall, movement of a small object)	Securely mount enclosure Check zone settings
The load will not work despite movement	Detection zone set is too small	Check zone settings

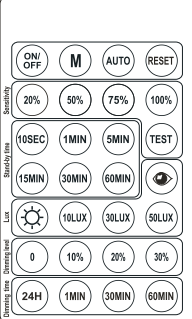
	<p>ON/OFF Press the on/off button, the light goes to permanent or permanent off mode, sensor is disabled.</p> <p>M Memory the parameters</p> <p>AUTO Press auto mode button, the sensor starts to work and all settings remain the same as the latest status before the light was switched on/off.</p> <p>TEST This button test 2s is for testing purpose only the sensor goes to test mode (hold time 2s) automatically after commissioning, meanwhile the stand-by period and daylight sensor are disabled.</p> <p>RESET One touch button, the default is 100% 10MIN 10MIN</p> <p>Sensitivity 20% 50% 75% 100% 10SEC 1MIN 5MIN 15MIN 30MIN 60MIN</p> <p>Hold-time 10SEC 1MIN 5MIN 15MIN 30MIN 60MIN</p> <p>Stand-by dimming level 0 10% 20% 30% 24H 1MIN 30MIN 60MIN</p> <p>Stand-by period (note: 24H is never off) 24H 1MIN 30MIN 60MIN</p>	<p>TEST This button test 2s is for testing purpose only the sensor goes to test mode (hold time 2s) automatically after commissioning, meanwhile the stand-by period and daylight sensor are disabled.</p> <p>RESET One touch button, the default is 100% 10MIN 10MIN</p> <p>Hold-time 10SEC 1MIN 5MIN 15MIN 30MIN 60MIN</p> <p>Stand-by dimming level 0 10% 20% 30% 24H 1MIN 30MIN 60MIN</p> <p>Stand-by period (note: 24H is never off) 24H 1MIN 30MIN 60MIN</p>
--	--	---



With sufficient natural light, the light does not switch on when presence detected.

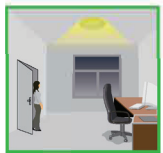

With insufficient natural light, the sensor switches on the light automatically when person enters the (options) standby level after the room. The lamp never switch off with presence, even the nature light is sufficient.



People left, light still dims to 0/10%/20%/30% (options) standby level after the hold time.



Light switches off automatically after the dimming time elapsed.