

BUSTER+PUNCH

LONDON

US DOOR LEVER HANDLE

PRE-DRILLED / PASSAGE / LINEAR / 41.5mm CENTRES

INSTRUCTION MANUAL US
MANUEL D'UTILISATION É -U
MANUAL DE INSTRUCCIONES (EE UU)

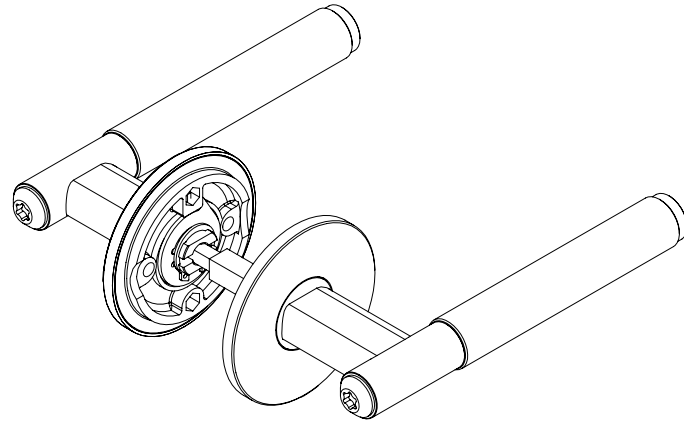

FITTINGS KIT CONTENTS



x1

ALLEN KEY
(2.5mm X 80mm X 20mm)



x2

BOLT BOSSES
(M4 X 33mm)



x2

THROUGH BOLTS
(M4 X 35mm)

x1

SPARE CUP
POINT GRUB
SCREW
(M4 X 6mm)

NOTE: WHEN DISASSEMBLING THE TWO LEVER HANDLES, KEEP THEIR PARTS SEPARATE AS THEY ARE NOT INTERCHANGEABLE

EN: USE: FOR RESIDENTIAL, INTERIOR USE ONLY.

DISCLAIMER: THIS PRODUCT IS NOT SUITABLE FOR COMMERCIAL USE. ALWAYS CONSULT A TRADE PROFESSIONAL WHEN INSTALLING THESE PRODUCTS. BUSTER + PUNCH IS NOT RESPONSIBLE FOR THE USAGE OR FEASIBILITY OF INSTALLATION REQUIREMENTS. THIS PRODUCT IS NOT SUITABLE FOR DAMP OR WET ENVIRONMENTS.

FR: UTILISATION : usage résidentiel. Pour l'intérieur seulement.

AVERTISSEMENT : ce produit ne convient pas à un usage commercial. Faites toujours appel à un professionnel pour installer ces produits. Buster + Punch n'est pas responsable de l'utilisation ou de la faisabilité des exigences d'installation. Ce produit ne convient pas aux environnements humides ou mouillés.

SP: USO: Para uso doméstico. Solo para uso interno. **AVISO LEGAL:** Este producto no es apto para uso comercial. Consulte siempre a un profesional del sector cuando vaya a instalar estos productos. Buster + Punch no se hace responsable de su uso ni de la viabilidad de los requisitos de instalación. Este producto no es adecuado para entornos húmedos o mojados.

BUSTERANDPUNCH.COM/US

L0241

1 REMOVE GRUB SCREWS WITH ALLEN KEY.

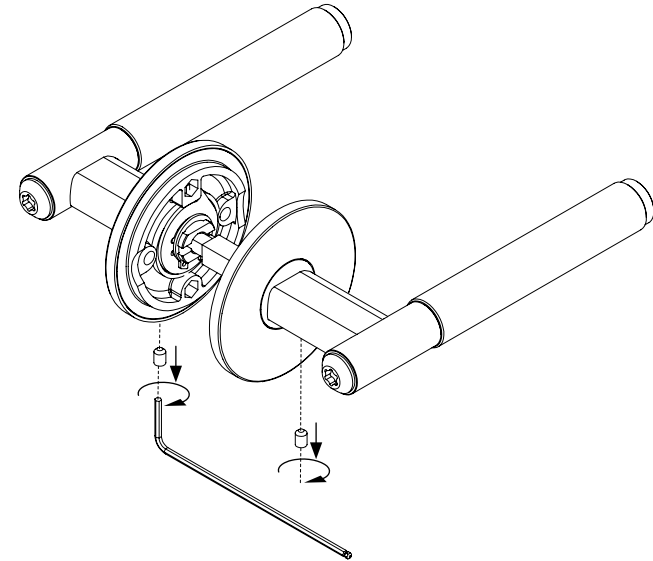

NOTE:

2 grub screws installed, 1 spare in fittings kit.

2 PULL APART LEVER HANDLES AND REMOVE SPINDLE.

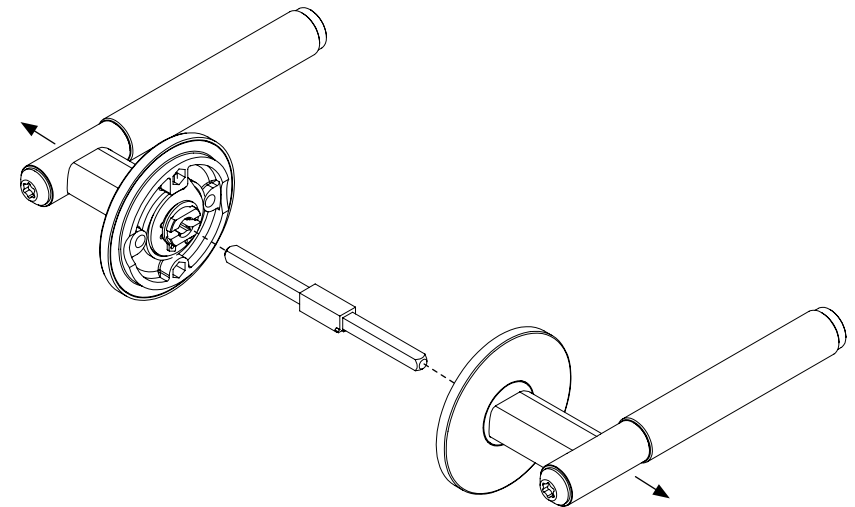

NOTE:

When disassembling the two lever handles, keep their parts separate as they are not interchangeable.

3 UNSCREW END CAP WITH TORX SCREWDRIVER.

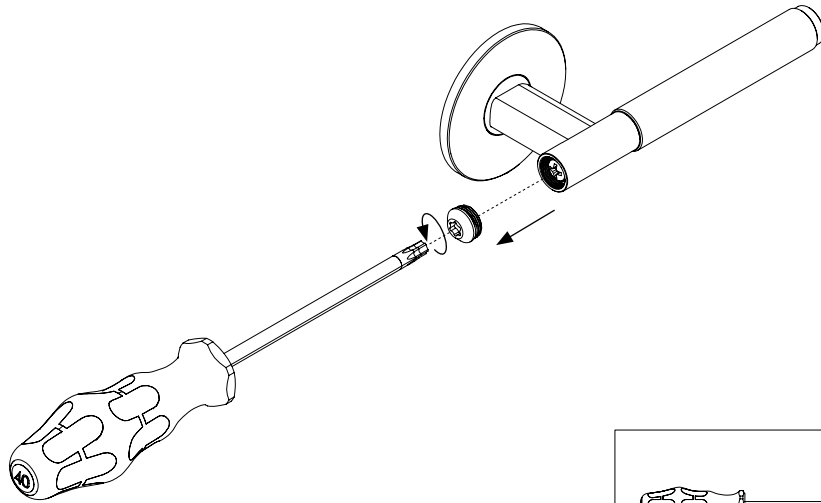

WARNING: Proceed with caution to avoid damaging the surface finish.

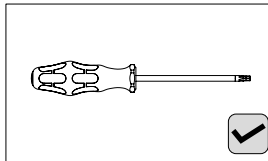

4 USE CROSS HEAD SCREWDRIVER TO REMOVE SCREW AND WASHERS FROM INSIDE OF THE LEVER HANDLE BAR.

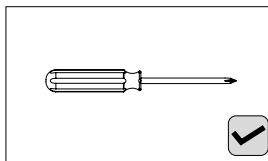
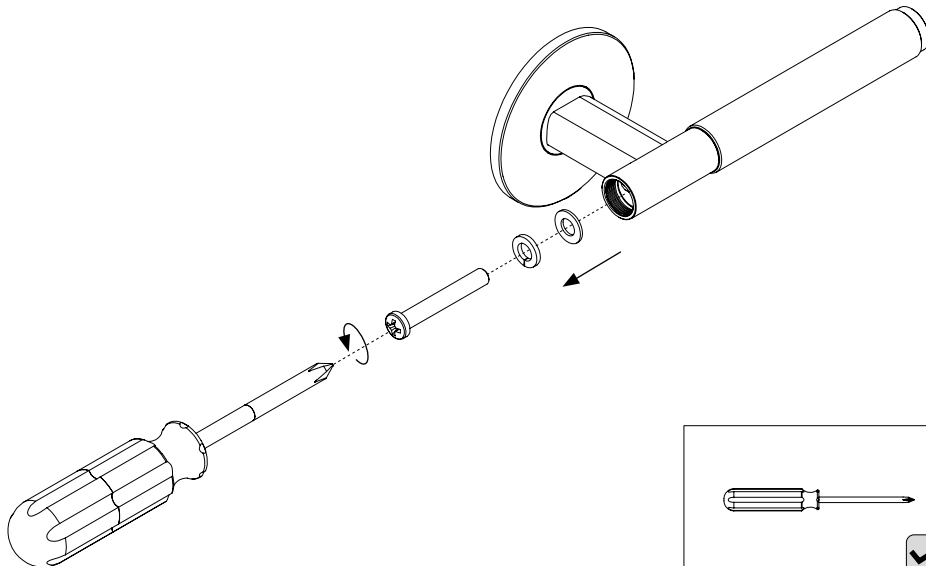

5 REMOVE BOTH LEVER HANDLE BARS FROM THEIR AXLES.

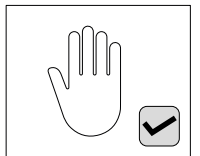
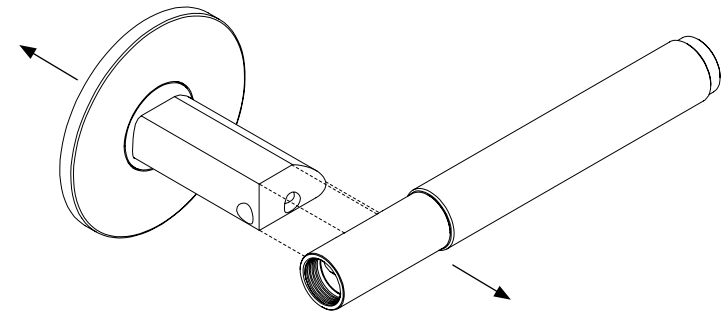

6 REMOVE ROSE COVER PLATES.

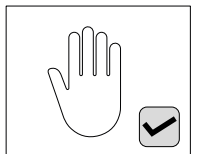
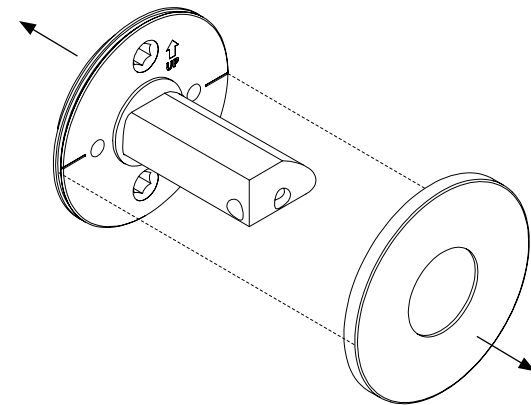

7 ASSEMBLE THE SPINDLE THROUGH THE LATCH. ENSURE THE SPINDLE IS PUSHED FULLY INTO THE LATCH AND CENTRAL.

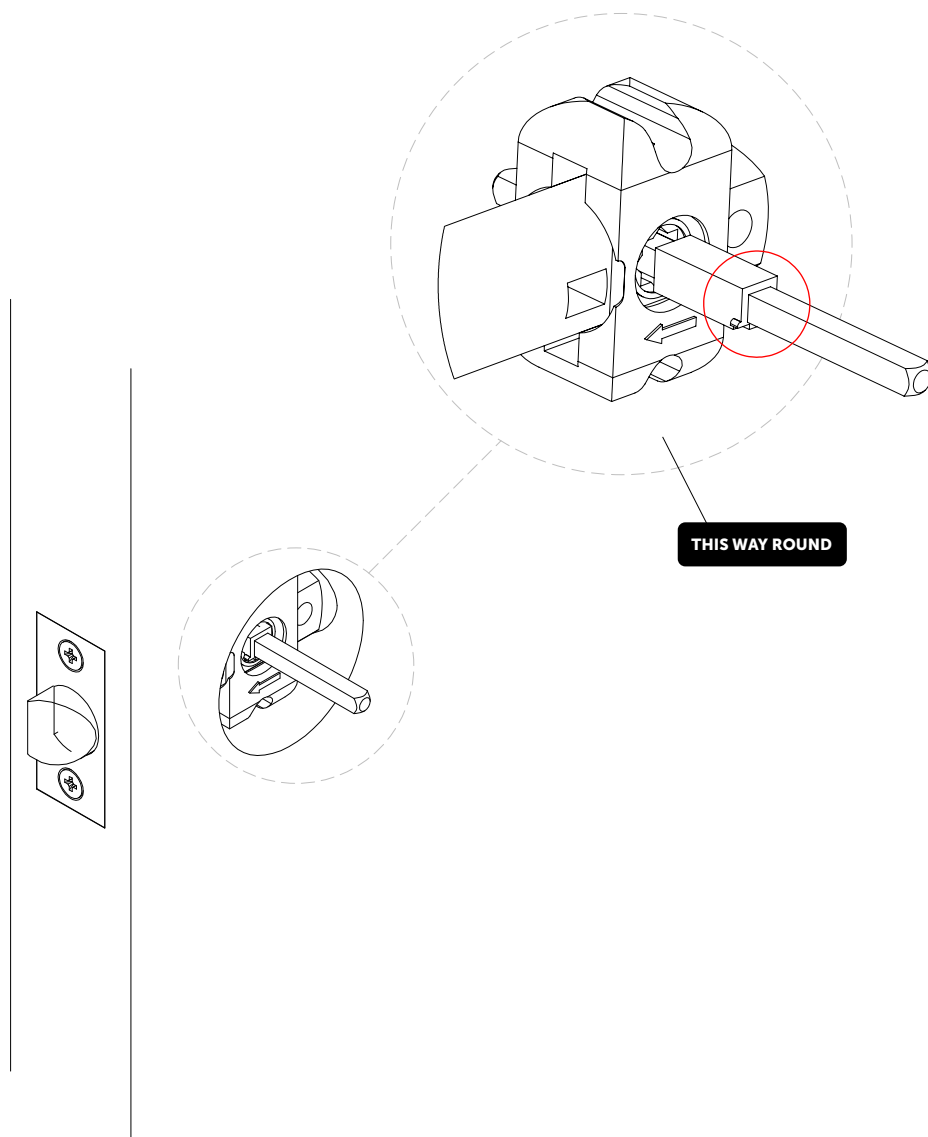

NOTE:

1. For information on the latch installation, scan the QR code on the latch box (if purchased).
2. Ensure the latch sits straight and true in the door recess.

8 A INSTALLING THE ROSES ONTO THE DOOR: Put the bolt bosses through the rose plate until they sit flush in the relevant recess:

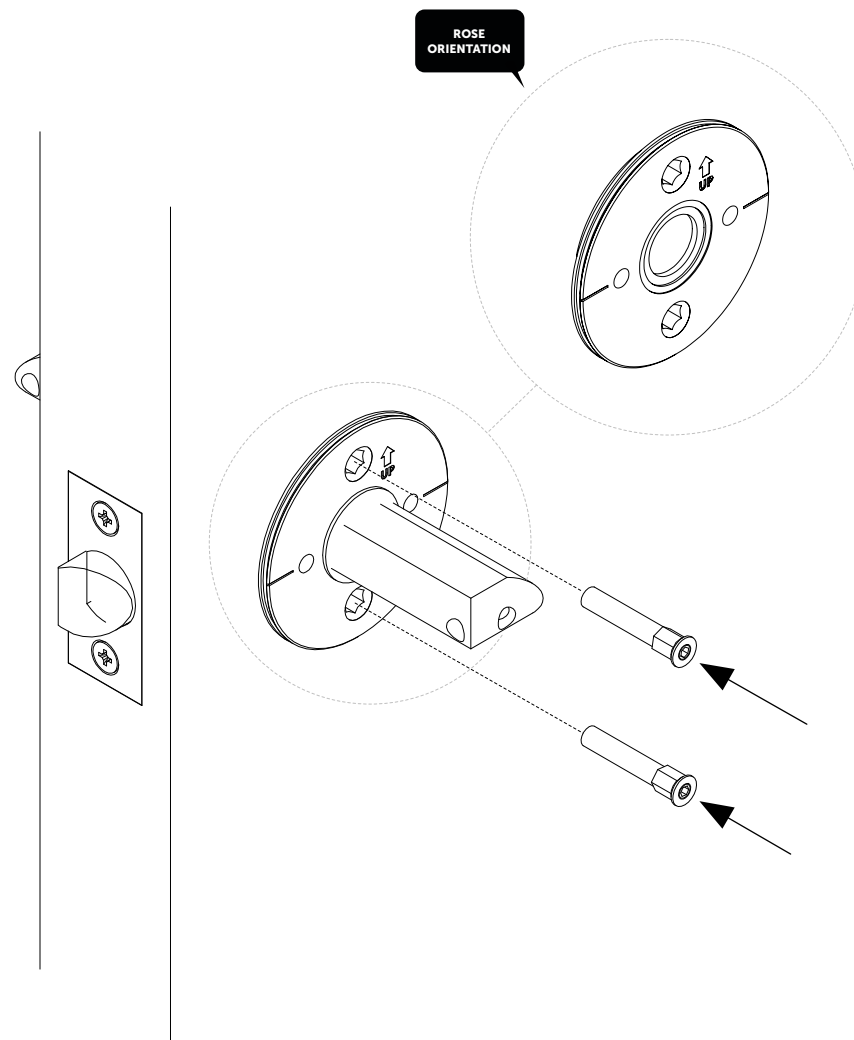

IMPORTANT:

- Ensure the up arrow is correctly orientated on the rose.
- Put the bolt bosses through the rose plate first (step 8A).
- Then install through bolts ensuring they are room-side (step 8B).
- During assembly, tighten the top and bottom through bolts evenly.



8 B

INSTALLING THE ROSES ONTO THE DOOR:

Screw the through bolts into the bolt bosses.

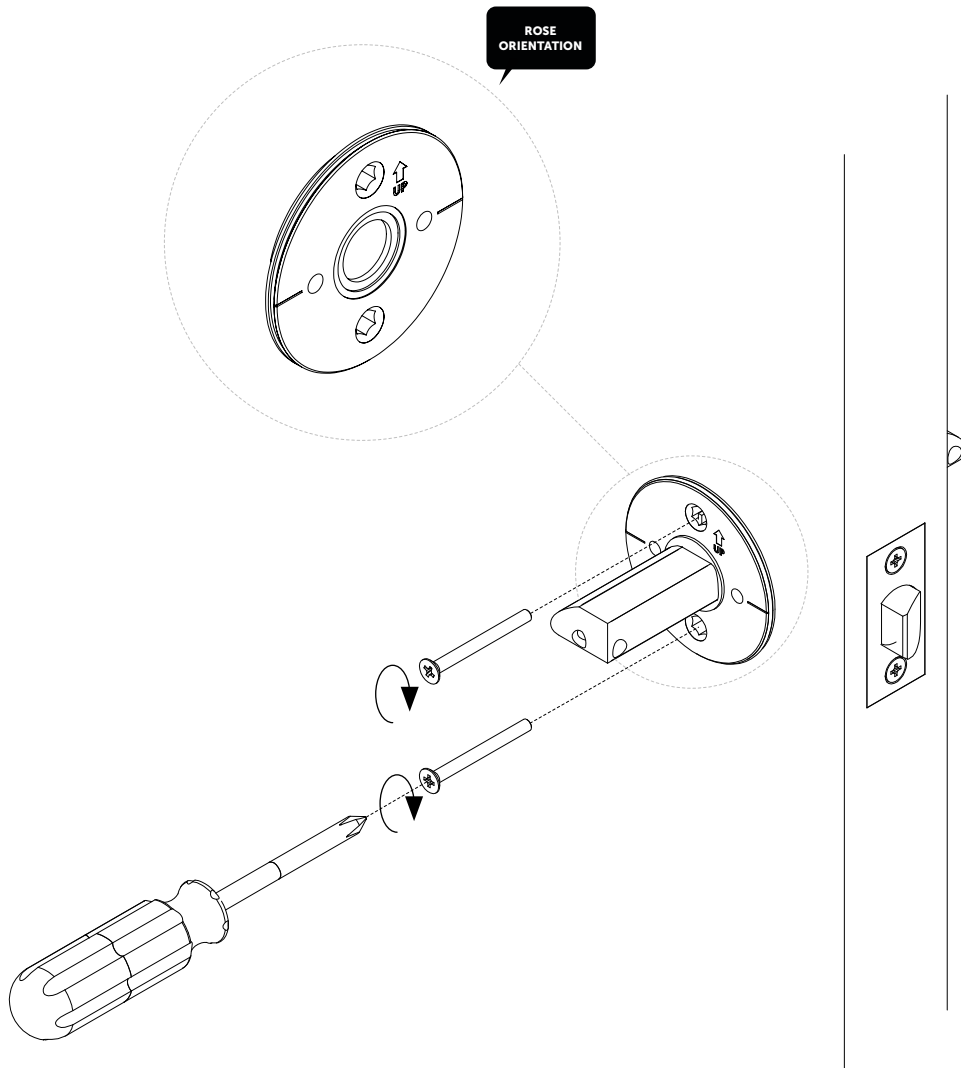

IMPORTANT:

- Ensure the up arrow is correctly orientated on the rose.
- Put the bolt bosses through the rose plate first (step 8A).
- Then install through bolts ensuring they are room-side (step 8B).
- During assembly, tighten the top and bottom through bolts evenly.

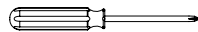

INSTALLATION CHECKS BEFORE FINAL ASSEMBLY:

1. Ensure the rose is flush and securely fitted to the door.
2. Place handles onto axles without screwing to test the following:
 - a) The lever handles rotate equally and the latch opens fully
 - b) The lever handles spring back to original position
 - c) The latch returns to the closed position



NOTE: If any issues arise, repeat previous installation steps 7 & 8.

3. Remove handles before continuing to step 9.

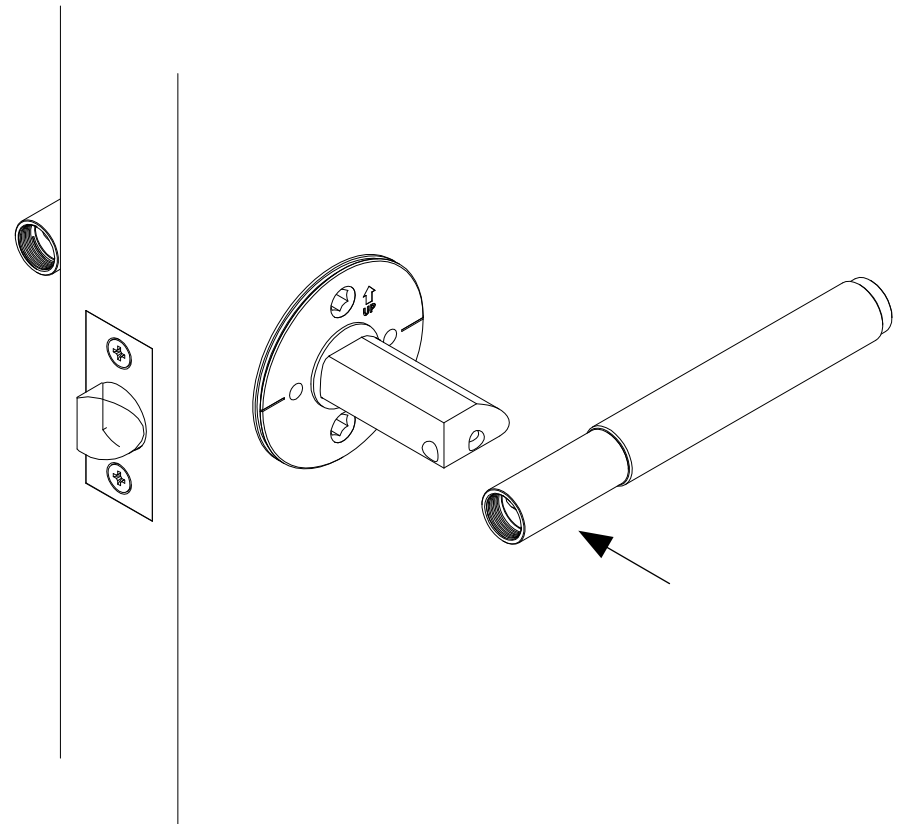

9 INSTALL ROSE COVER PLATES.

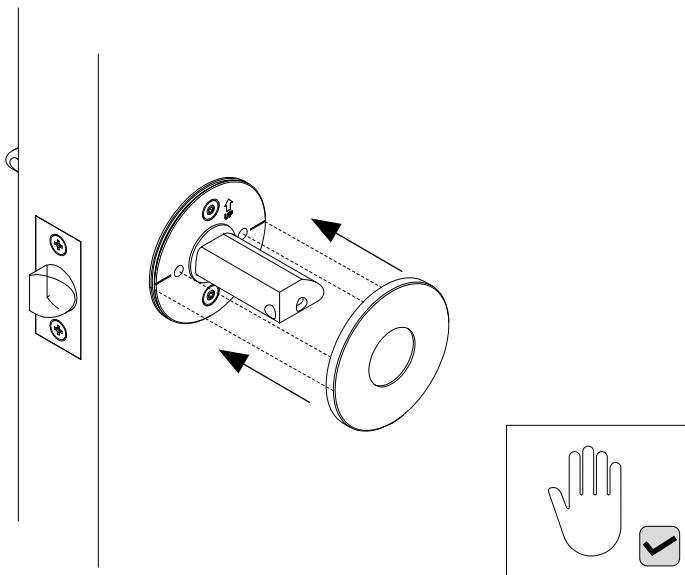

10 INSTALL LEVER HANDLE BARS.

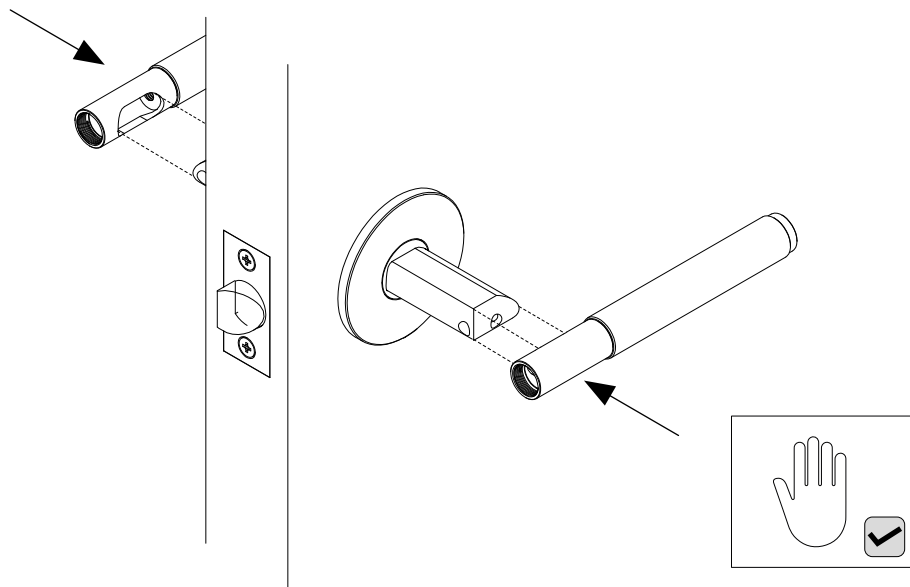

11 USE CROSS HEAD SCREWDRIVER TO INSTALL SCREW AND WASHERS INSIDE LEVER HANDLE BAR AND SCREW ON END CAP UNTIL FINGER TIGHT.

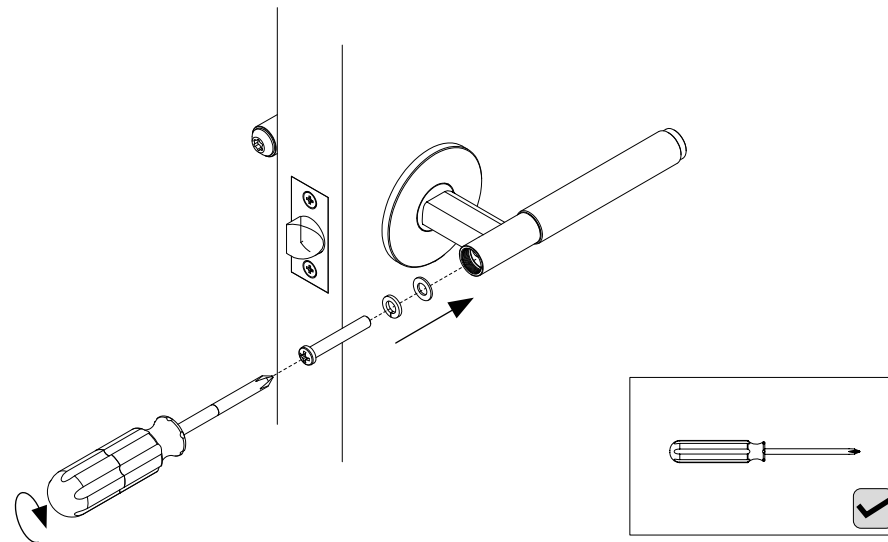

12 SCREW ON END CAPS WITH TORX SCREWDRIVER.

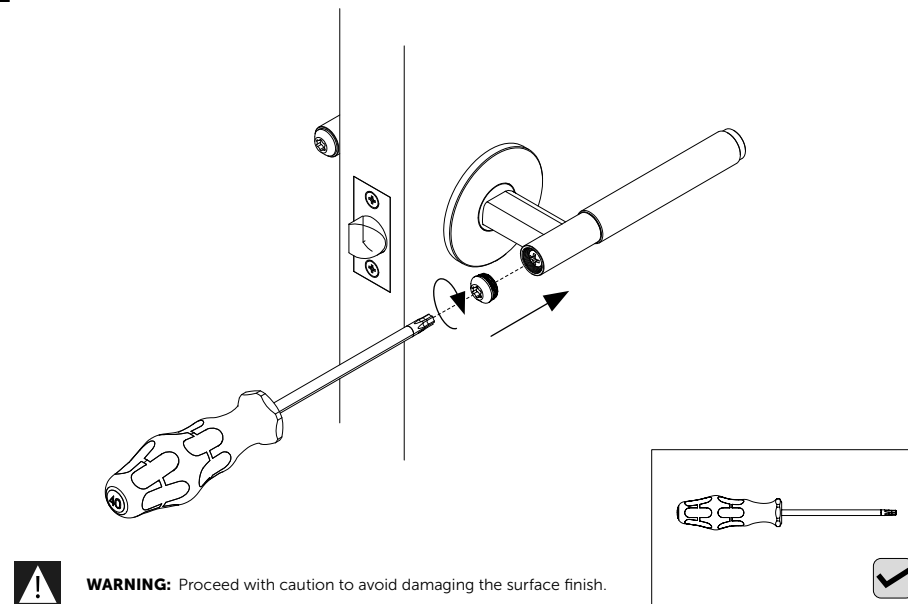

13 INSTALL GRUB SCREWS WITH ALLEN KEY.

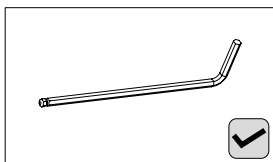
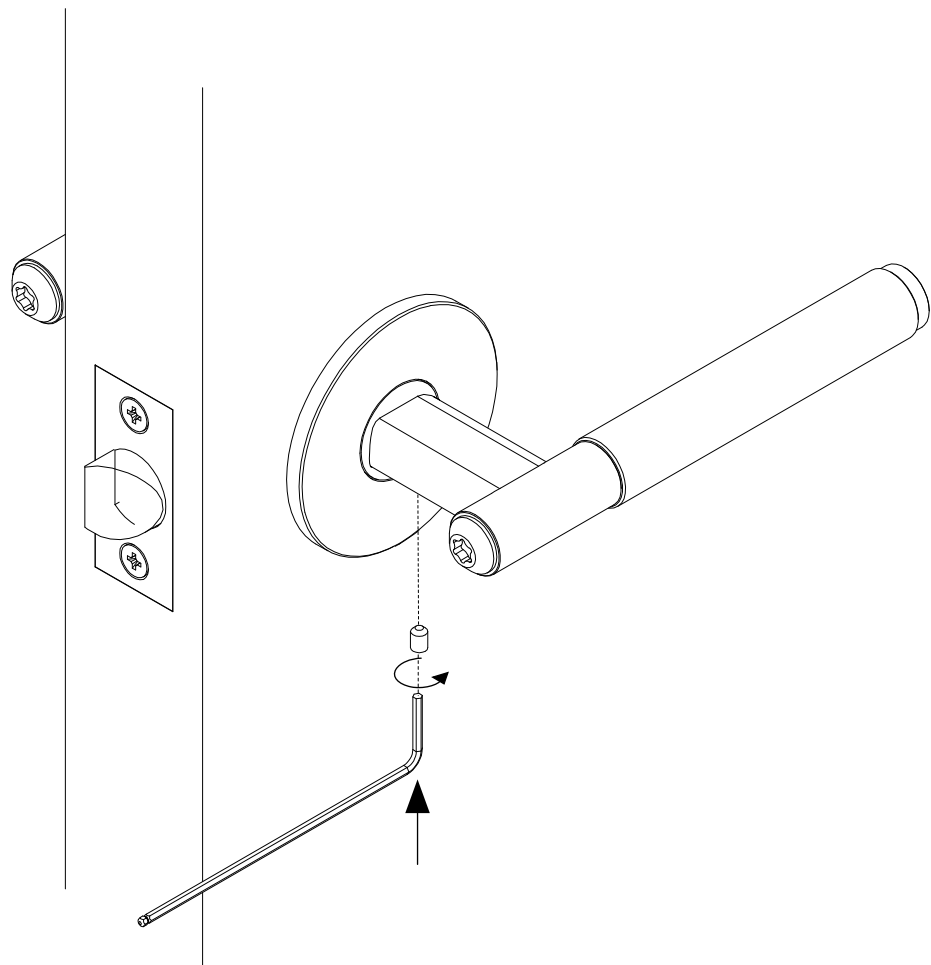

[end. **ORDINARY**]