

**ANZ TOGGLE SWITCH
INSTALLATION MANUAL**

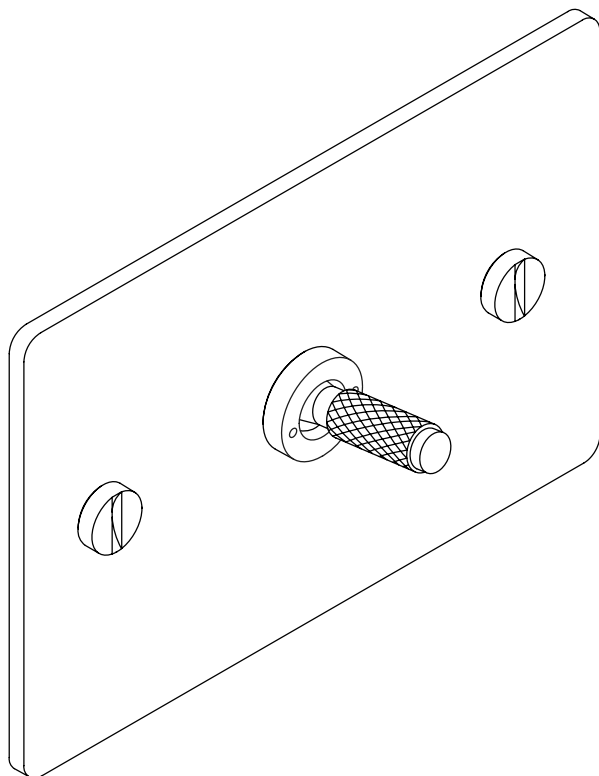

**EN
TECHNICAL SPECIFICATION**

1G - 4G TOGGLE SWITCH
250VAC / 10A Max / Class II

IMPORTANT NOTES

READ BEFORE INSTALLATION

1. All wiring and installation must adhere to the latest local and national regulations.
2. Must be installed by a licensed electrician.
3. Do not exceed the rated power values.
4. Indoor use only.
5. To reduce the risk of discolouration or tarnishing, avoid installation on wet plaster.



AS/NZS 3133:2013 + A1:2014 + A2:2016

WARRANTY INFORMATION

The warranty period extends two (2) years from the date of the original purchase.

RECYCLING ELECTRICAL PRODUCTS

Buster and Punch encourages all its customers to make note of this symbol and avoid putting any waste electrical goods in your domestic waste bin or container. Please ensure you take your waste electrical goods to a suitable facility for disposal.



- 1 TURN OFF POWER.**
BEFORE COMMENCING WORK, ISOLATE THE MAINS POWER SUPPLY AT THE CIRCUIT BREAKER.

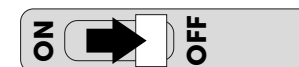

CAUTION:

Verify power supply is OFF before proceeding.

- 2 IF UNIT IS TO BE USED AS A REPLACEMENT FOR AN EXISTING PRODUCT, REMOVE EXISTING UNIT FROM ITS LOCATION AND DISCONNECT THE WIRING.**

- 3 REMOVE THE UNIT FROM ITS PACKAGING. REMOVE THE COIN CAP SCREWS (A) USING TOOL PROVIDED. IF NOT RELEASED WITH THE COIN CAP SCREWS, UNSCREW THE ISOLATOR PLUGS (B). THIS WILL REVEAL THE MOUNTING SCREWS REQUIRED FOR INSTALLATION (C).**

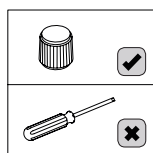
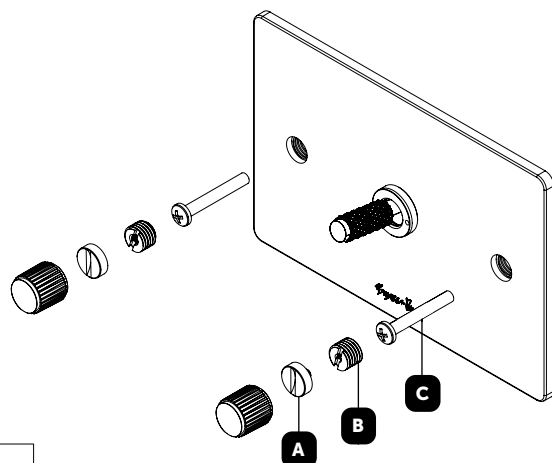

! TO AVOID DAMAGE TO THE COIN CAPS, ALWAYS FASTEN USING THE PLASTIC TOOL PROVIDED.

4 OPTIONAL: BLING YOUR TOGGLE SWITCH

REQUIRES TOGGLE DETAILS KIT. IF YOU DO NOT WISH TO CHANGE TOGGLE DETAILS, PROCEED TO STEP 5.

A) UNSCREW THE EXISTING TOGGLE ARM BY HAND, AND SET ASIDE.

B) HOLDING THE TOGGLE MODULE IN PLACE, UNSCREW THE TOGGLE NUT USING THE TOOL PROVIDED. REVERSE THIS STEP TO FIT THE NEW TOGGLE NUT, TAKING CARE NOT TO CROSS THE THREAD.

C) WITH THE NUT IN PLACE, SCREW ON THE TOGGLE ARM FROM YOUR DETAILS KIT. NOTE: COIN CAPS FITTED AFTER INSTALL.

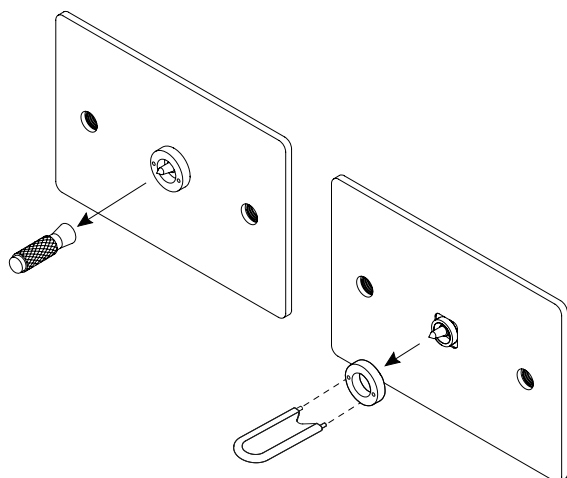

- 5 CONNECT THE WIRES AS SHOWN IN THE APPROPRIATE WIRING DIAGRAM. USE RED OR BROWN SLEEVING TO MARK CABLES USED FOR ACTIVE OR SWITCHED ACTIVE CONNECTIONS.**

ENSURE TERMINALS ARE PROPERLY TIGHTENED AND NO BARE WIRE IS VISIBLE.

5 a) 1 WAY SWITCHING ON TYPICAL LOOPED CIRCUIT

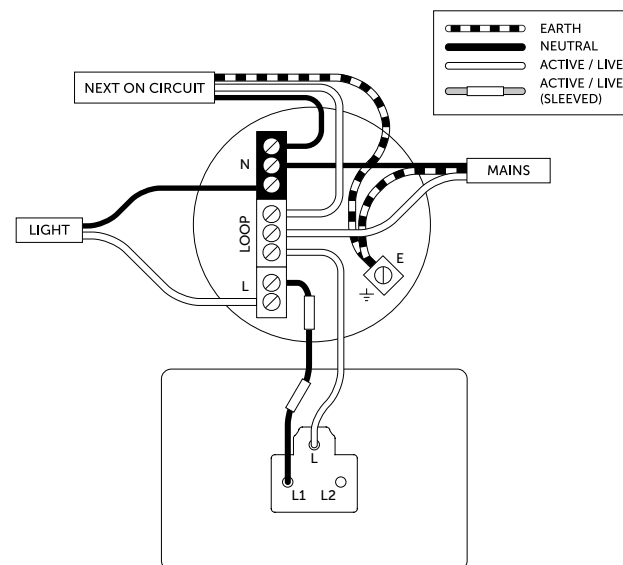

PRE-EXISTING EARTH CABLES SHOULD BE CAPPED INSIDE THE BACKBOX.

5 b) 2 WAY SWITCHING ON TYPICAL LOOPED CIRCUIT

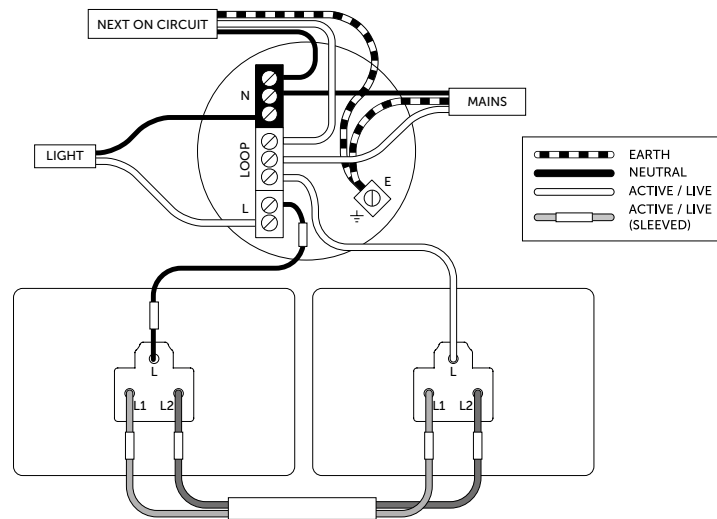

PRE-EXISTING EARTH CABLES SHOULD BE CAPPED INSIDE THE BACKBOX.

- 6** PUSH THE WIRED UNIT INTO THE MOUNTING BOX, MAKING SURE THAT NO WIRES BECOME TRAPPED. USE A CROSS HEAD SCREWDRIVER TO FIT THE UNIT TO THE BACKBOX VIA THE TWO MOUNTING SCREWS AS SHOWN. TO FINISH, FIT THE COIN CAPS AND ISOLATOR PLUGS USING THE TOOL PROVIDED.

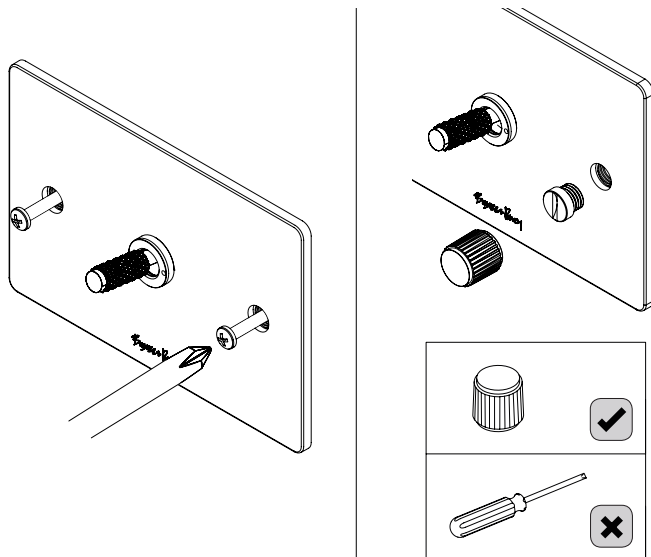

7

ONCE SAFELY FITTED, RECONNECT THE MAINS SUPPLY AT THE CIRCUIT BREAKER.



HOW TO BUILD YOUR CUSTOM TOGGLE SWITCH

[range. **ELECTRICITY.**]

[knurl. **CROSS.**]

[deatil. **COIN SCREWS.**]

All products are available in solid finishes, customisable with interchangeable details kits to suit any interior. Requires appropriate details kit.

1

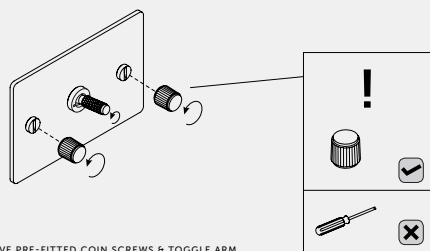

REMOVE PRE-FITTED COIN SCREWS & TOGGLE ARM.

2

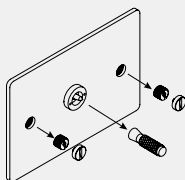

3

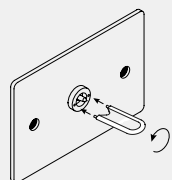

4

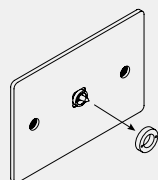

5

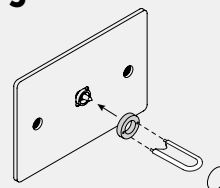

REPLACE WITH COIN SCREWS & TOGGLE ARM FROM YOUR DETAILS KIT.

6

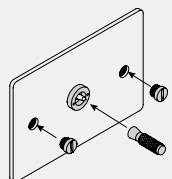

7

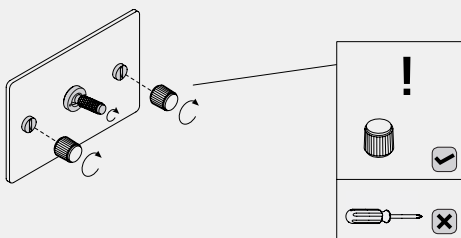

[end. **ORDINARY**]