

**HOOK / CAST**  
**INSTALLATION MANUAL**

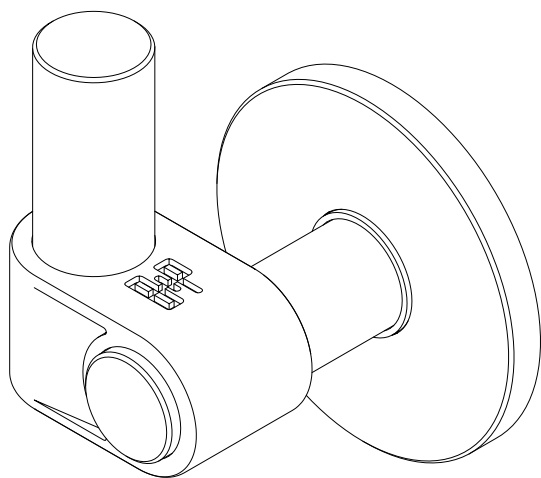

**CONTENTS**  
NOT TO SCALE

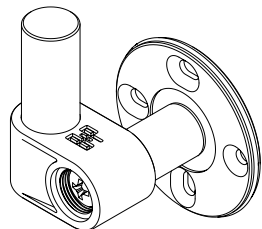

**x1**  
HOOK  
ASSEMBLY

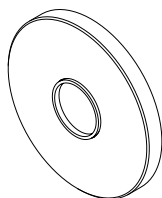

**x1**  
ROSE COVER  
PLATE



**x1**  
END CAP

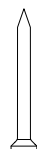

**x4**  
3.5 MM  
SCREWS



**x4**  
3.5 MM  
WALL PLUGS

**1** **DISASSEMBLE HOOK ASSEMBLY.**

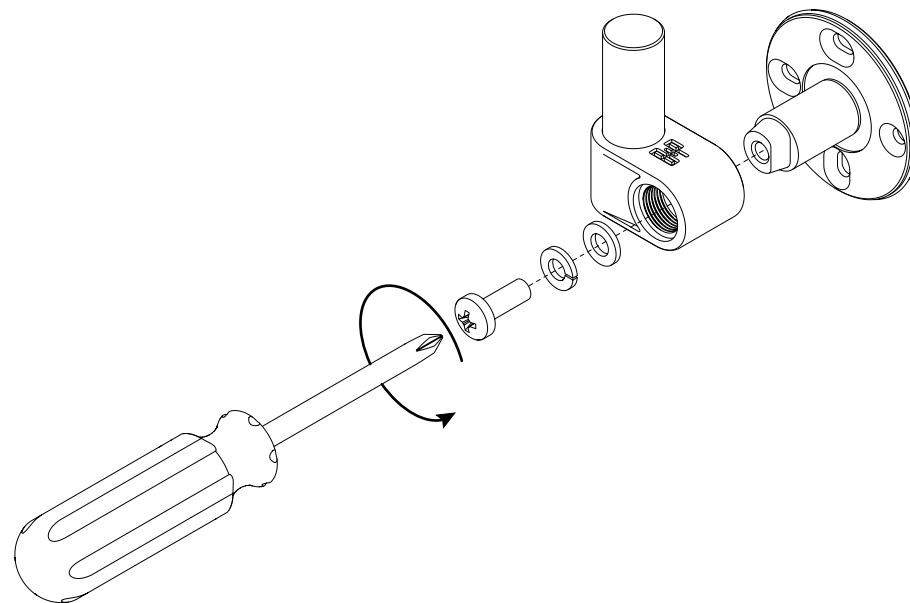

**2** **MARK FIXING HOLES.**

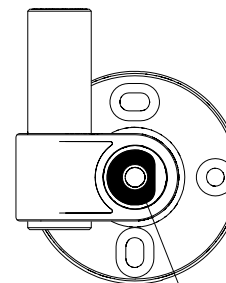

**NOTE: ORIENTATION OF  
MOUNTING ROD -  
FLAT FACING RIGHT**

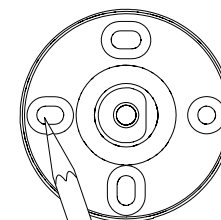

**MARK WITH THE  
PENCIL**

**3** DRILL HOLES IN WALL / SURFACE AND INSERT WALL PLUGS.

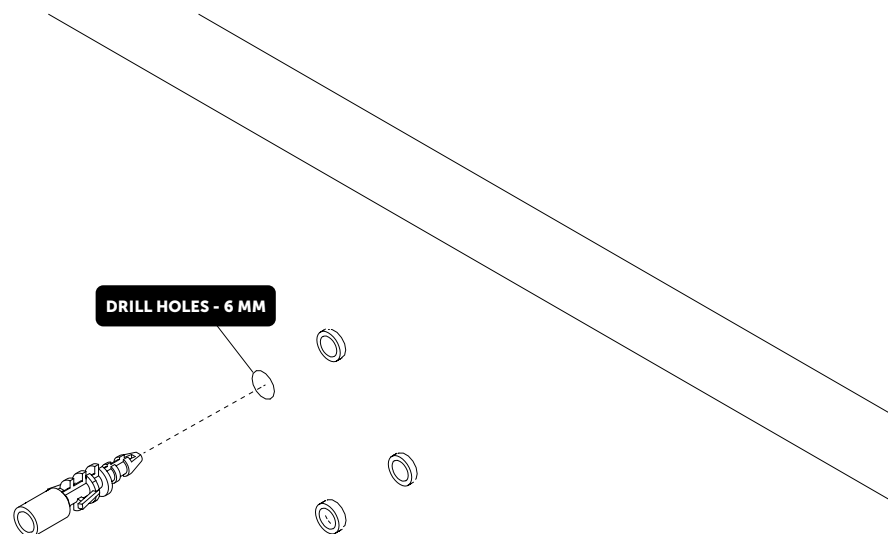

**4** SCREW FIXING ROSE TO WALL.

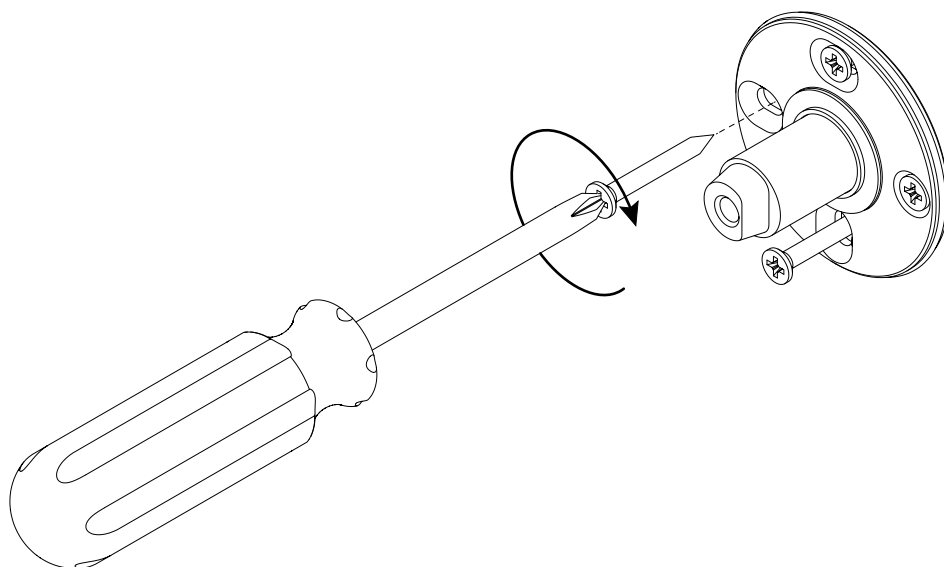

**5** FIT COVER PLATE TO FIXING ROSE.

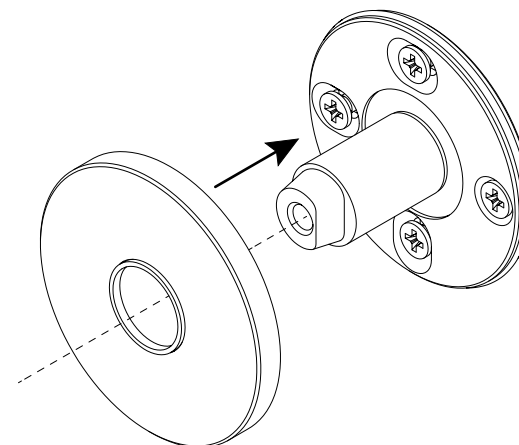

**6** ATTACH HOOK KNUCKLE.

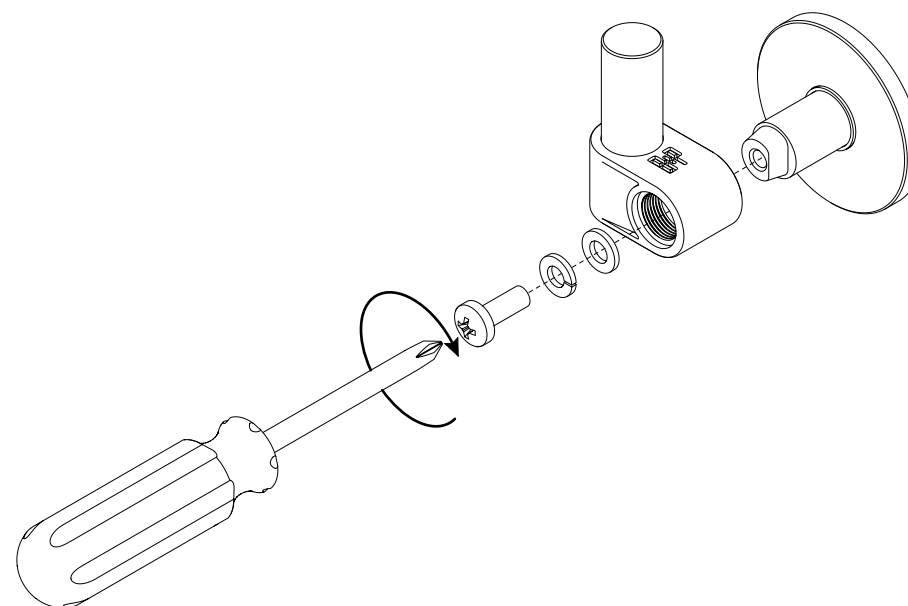

## 7 SCREW IN END CAP.

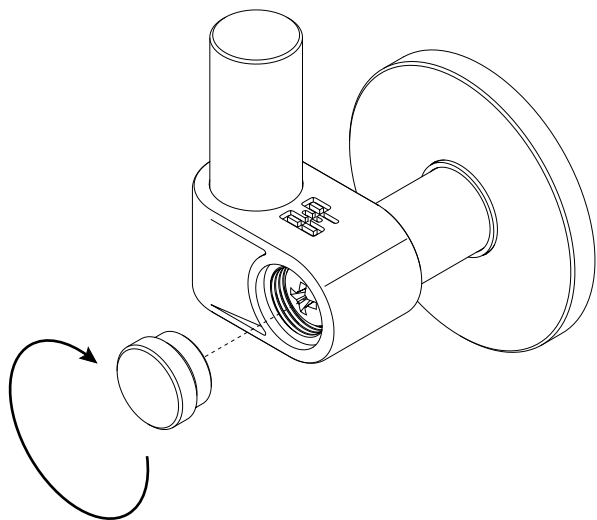

[end. **ORDINARY** ]

