

BUSTER + PUNCH

LONDON

TUBULAR LATCH DOOR PREPARATION AND INSTALLATION

INSTRUCTION MANUAL

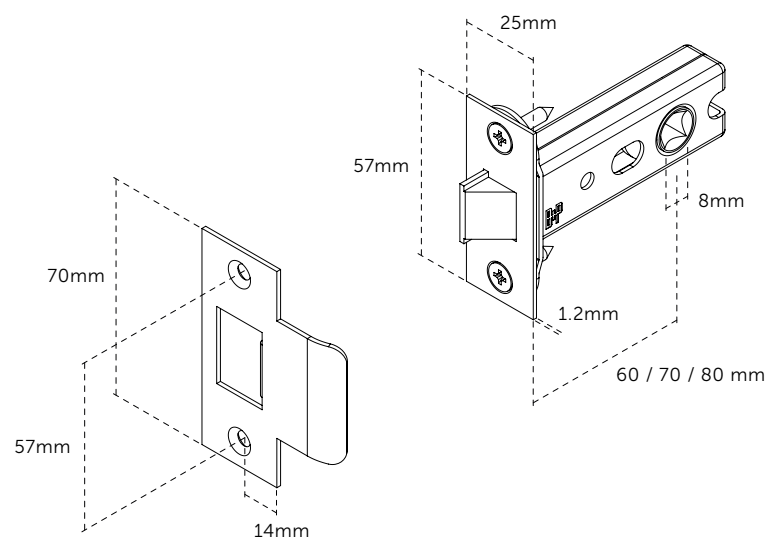

BUSTERANDPUNCH.COM/AU

CONTENTS

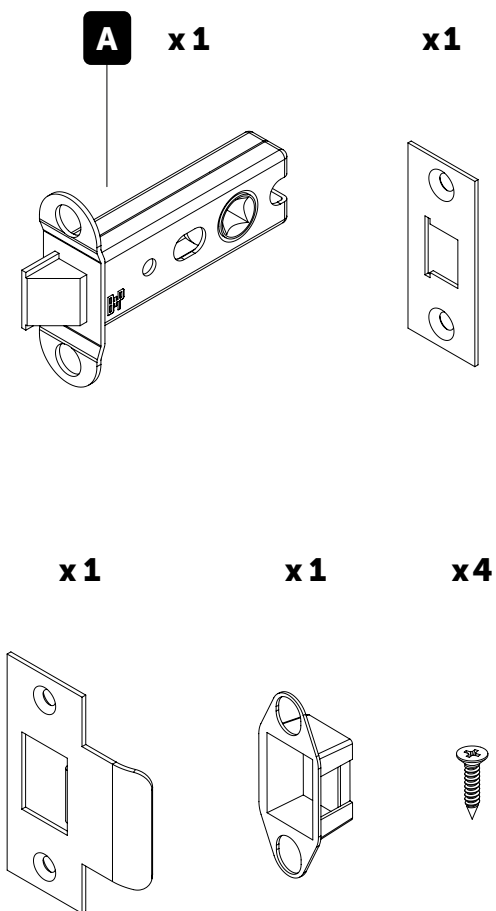

ABOVE DIMENSIONS APPROXIMATE. USE PARTS AS TEMPLATES FOR DOOR PREPARATION.

NOTE: INSTALLATION INSTRUCTION MANUAL APPLICABLE FOR US TUBULAR LATCHES SUPPLIED BY BUSTER + PUNCH. PRODUCT VARIATIONS COVERED BY THIS INSTRUCTION MANUAL ARE LISTED BELOW:

TUBULAR LATCH / FOR DOOR HANDLE / 60 mm, 70 mm BACKSET
TUBULAR LATCH / FOR DOOR KNOB / 80 mm BACKSET

1 DOOR JAM PREPERATION

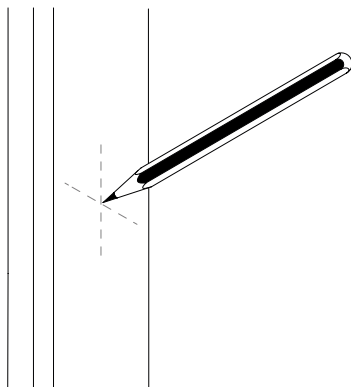

2

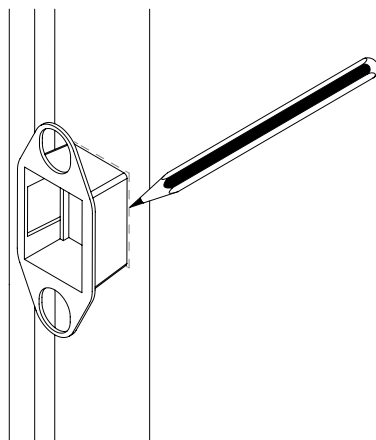

3

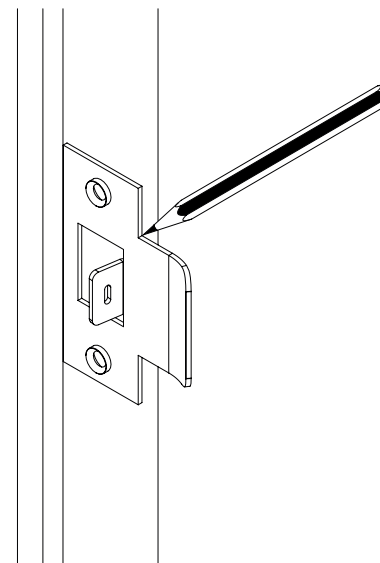

4 CHISEL UNTIL
FACE PLATE
FLUSH.

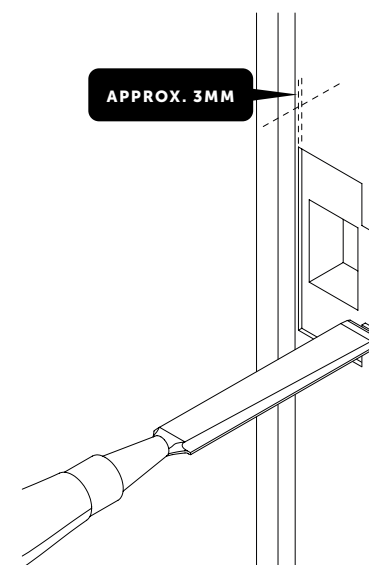

5

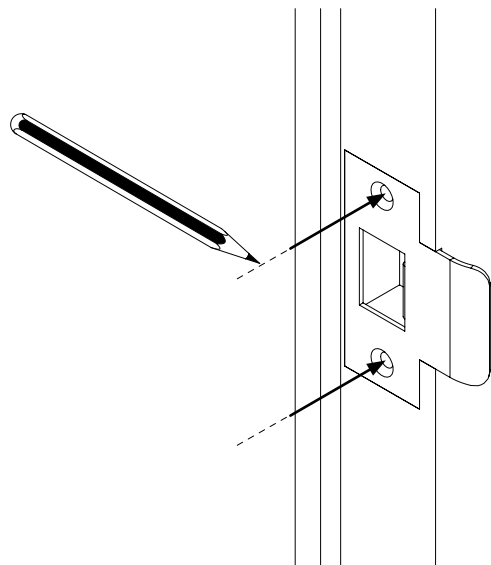

6

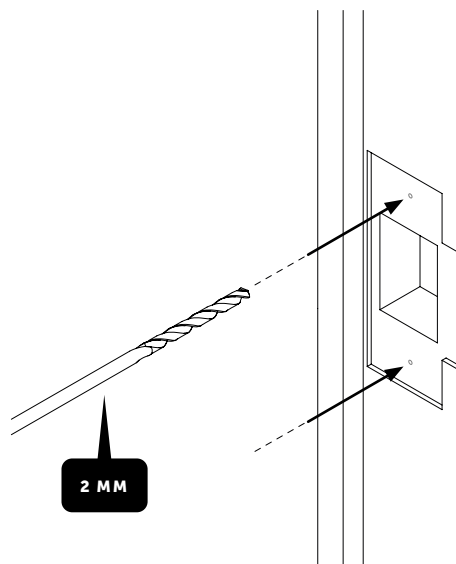

7

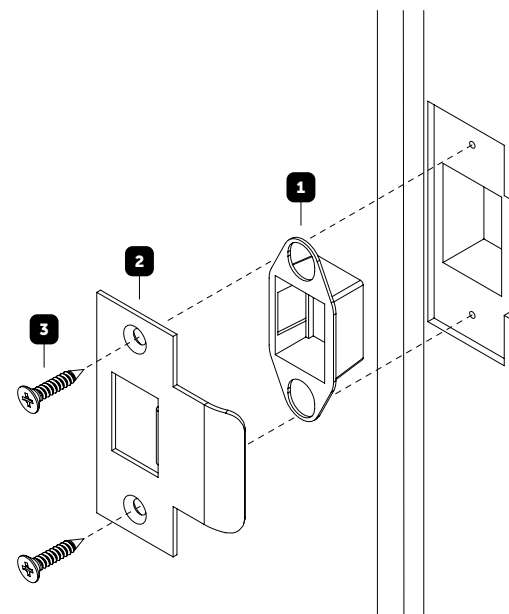
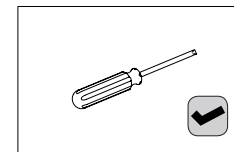

1 DOOR PREPARATION

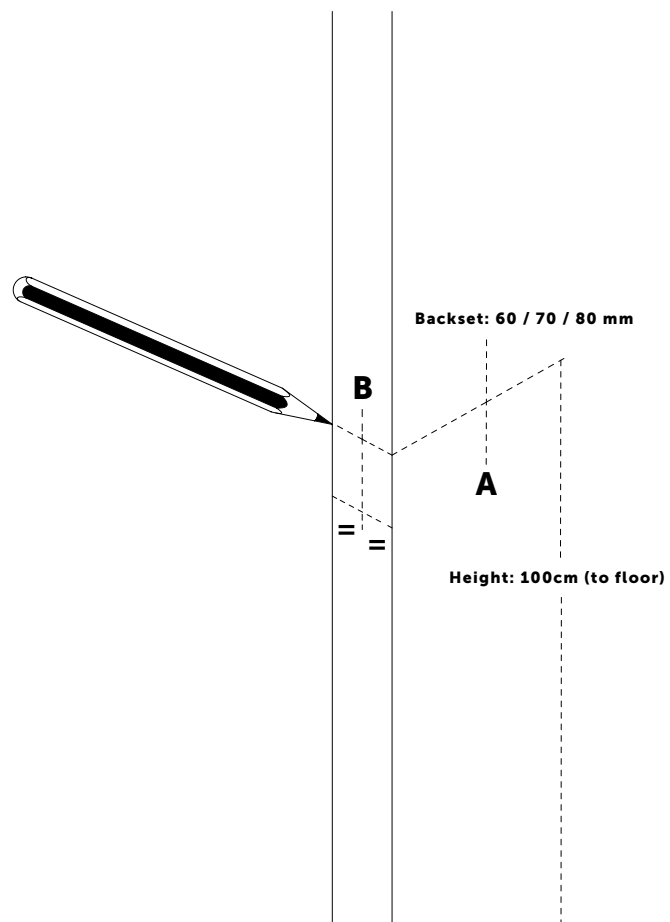

2

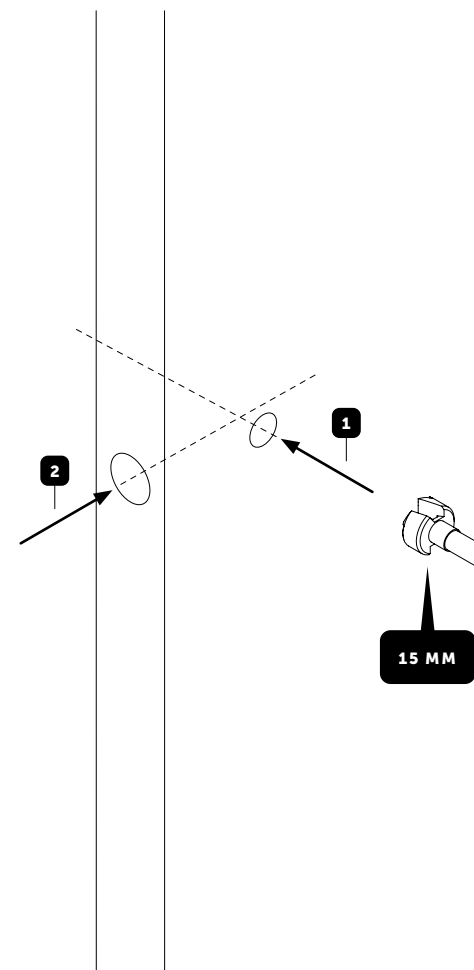

3

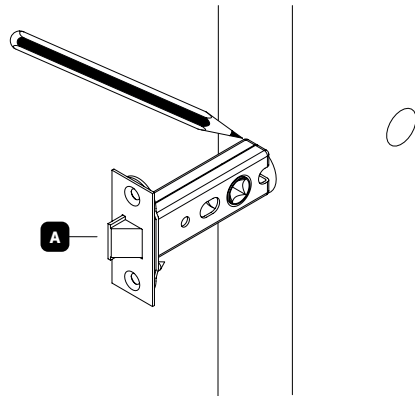

5

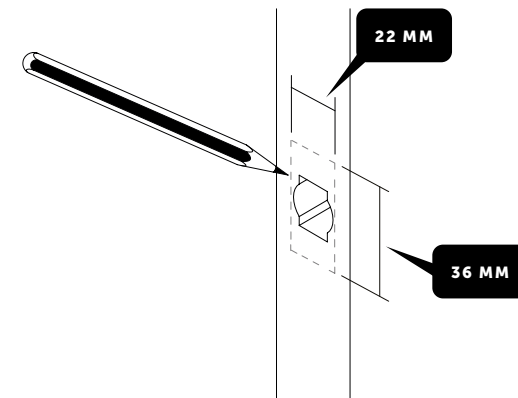

4

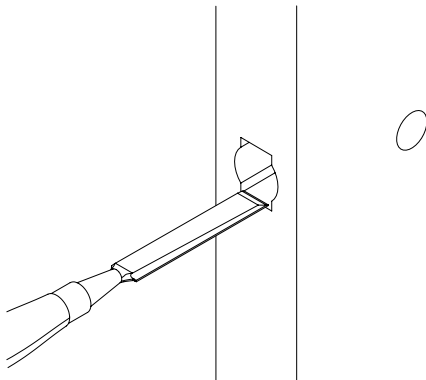

6

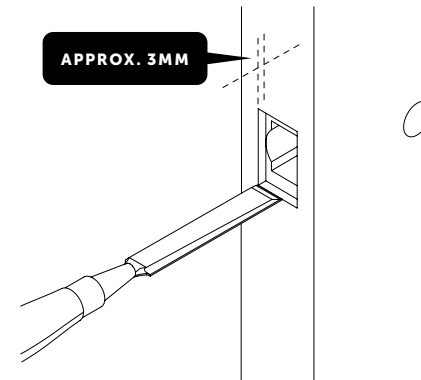

7

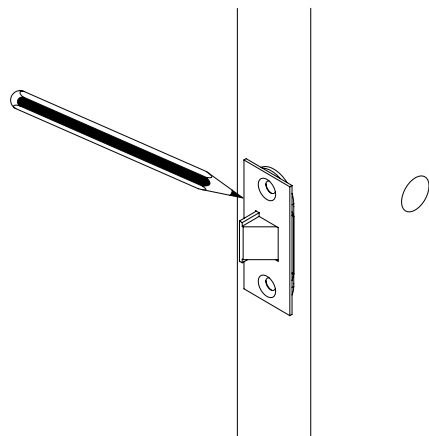

8 CHISEL UNTIL
FACE PLATE
FLUSH.

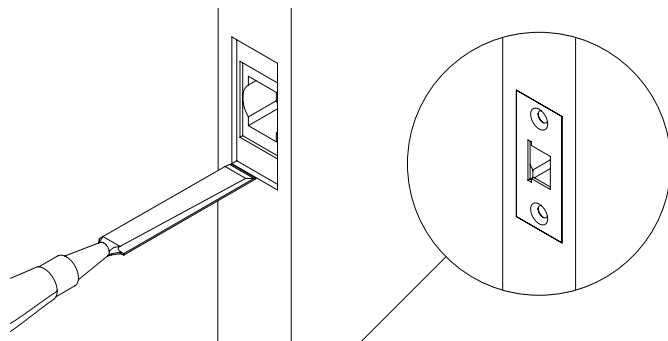

9

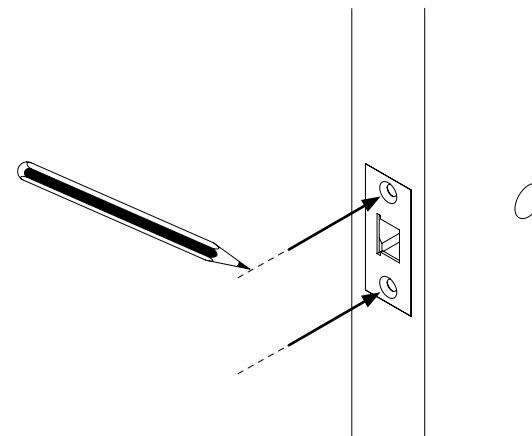

10

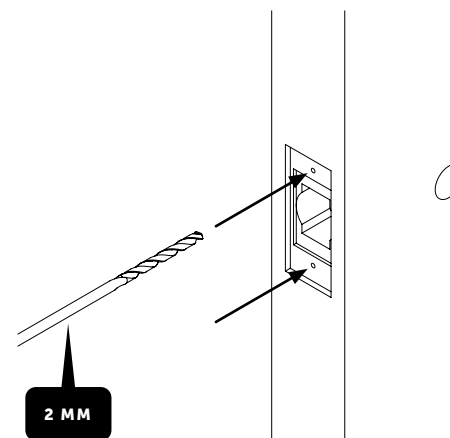

11

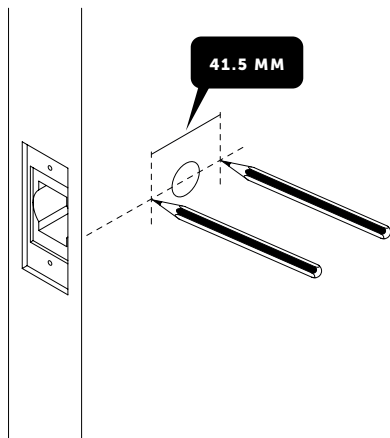

12

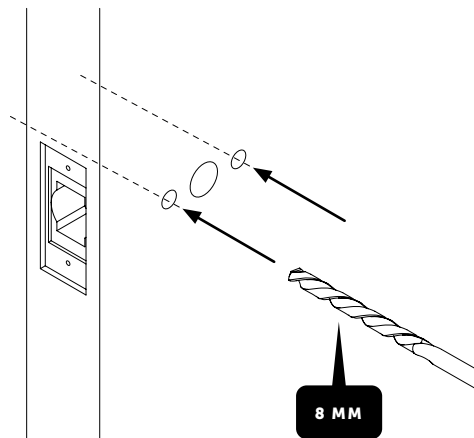

13

