

**ESCUTCHEON PLATES  
ANZ OVAL PROFILE**

**INSTRUCTION MANUAL**

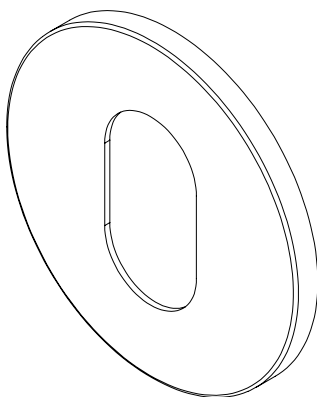

**CONTENTS**

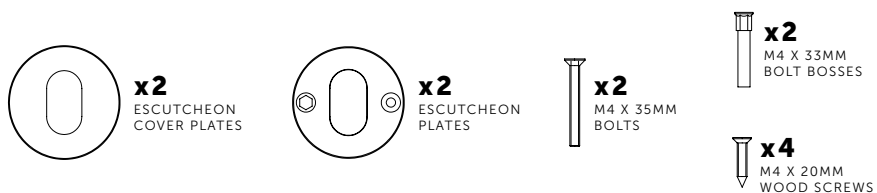

**ANZ: FOR RESIDENTIAL USE. INTERIOR DOORS ONLY.**

**DISCLAIMER: THIS PRODUCT IS NOT SUITABLE FOR COMMERCIAL USE. ALWAYS CONSULT A TRADE PROFESSIONAL WHEN INSTALLING THESE PRODUCTS. BUSTER + PUNCH IS NOT RESPONSIBLE FOR THE USAGE OR FEASIBILITY OF INSTALLATION REQUIREMENTS.**

**1** PUSH BLACK CARD TO REMOVE ESCUTCHEON COVER PLATE FOR INSTALLATION.

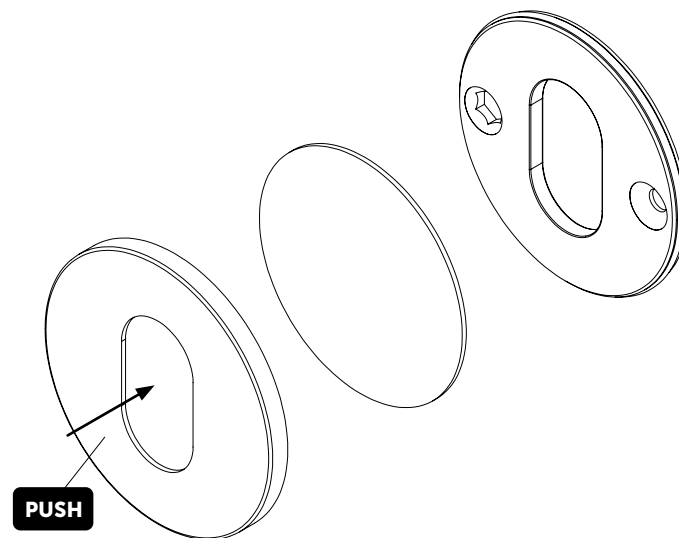

**2 a** ESCUTCHEON INSTALLATION WITH THROUGH BOLTS ( DOUBLE SIDED ).

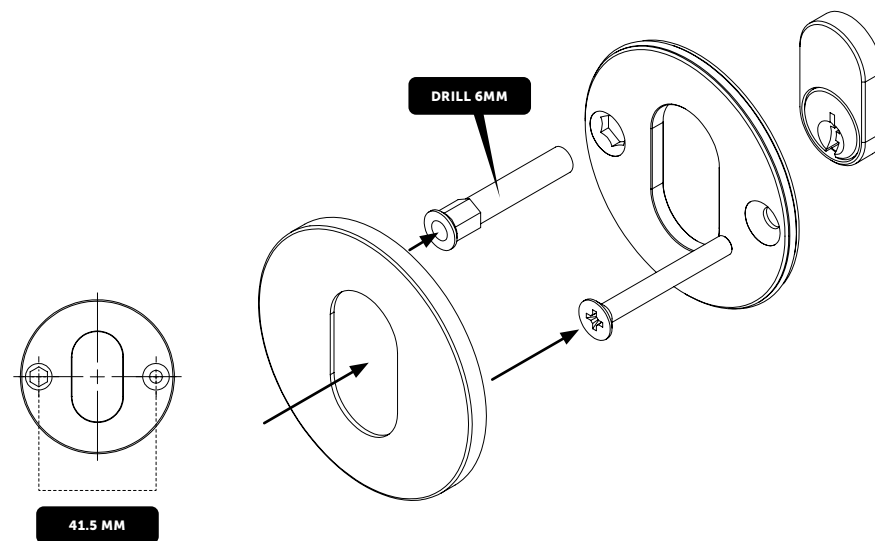

## 2 b ESCUTCHEON INSTALLATION WITH WOOD SCREWS ( SINGLE OR DOUBLE SIDED )

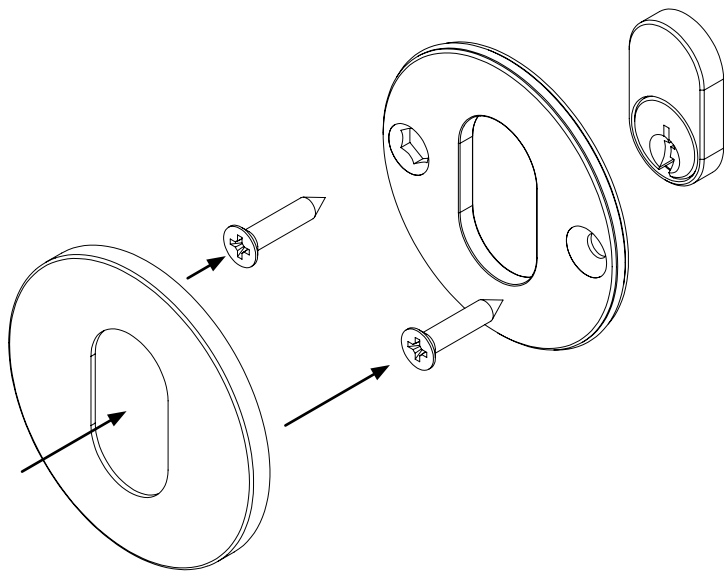

[end. **ORDINARY** ]